

MADE IN ITALY

CATALOGO

 FIMET



Siavuk Vithes



MADE IN ITALY



www.fimet-handles.com



La **Fimet** maniglie nasce nel 1986 per servire principalmente il mercato tedesco.

Grazie all'impegno della famiglia Bianchi, si è costantemente sviluppata fino ad arrivare, ad oggi, a servire oltre 20 mercati.

La prototipazione e lo studio di nuovi modelli di maniglie adatte a soddisfare le esigenze dei clienti presenti nei diversi mercati serviti è testimoniata dalla vasta gamma di coordinati, che sono prodotti nel rispetto ambientale e con materiali di prima qualità.

L'impegno volto alla ricerca di soluzioni tecniche mirate a rispondere ai requisiti dei nostri clienti sono garanzia di fornitura di prodotti di qualità superiore.

Flessibilità e professionalità sono due vocaboli che da oltre 25 anni fanno parte del nostro quotidiano.

Vittore e i suoi figli si impegnano infatti ad offrire ai clienti soluzioni mirate per qualsiasi problema tecnico e cercano di facilitare il marketing dei prodotti attraverso lo studio di promozioni personalizzate, imballaggi ed espositori che ben si adattino ad ogni tipo di esigenza.

Il carattere familiare dell'azienda è infatti il suo punto di forza "Non ci limitiamo a produrre maniglie, ne curiamo ogni aspetto, dalla ideazione fino alla finitura, siamo orgogliosi di rappresentare il Made in Italy."

Di recente abbiamo ottenuto la certificazione classe 3 e classe 4 presso l'istituto IFT di Rosenheim e quella antifuoco presso l'IBS per aiutare i ns. clienti a commercializzare una gamma completa sotto tutti i punti di vista.

The company **Fimet** maniglie was founded in 1986 to serve primarily the German market.

Thanks to the efforts of the Bianchi family, it has constantly developed and nowadays it serves more than 20 markets.

Prototyping and study of new models of handles adapted to meet the needs of customers in the various markets served is evidenced by the wide range of coordinated, which are produced in compliance with environmental rules and with quality materials.

The commitment to find technical solutions to meet the requirements of our customers are a guarantee of the supply of high quality products.

Flexibility and professionalism are the two words that for over 25 years are part of our daily lives.

Vittore and his sons efforts are focused to provide customers with tailored solutions for any technical problems and seek to facilitate the marketing of the products through the study of personalized promotions, packing and exhibitors stand that can be adapted to every need.

The family character of the company is its strength "We do not just produce handles, we take care of every aspect from conception to finish, we are proud to represent the Made in Italy."

We recently obtained certification class 3 and class 4 at the institute IFT Rosenheim and the fireproof at the IBS to help our customers to market a full range under all points of view.



La ditta **Fimet** si è sempre distinta per la costante ricerca di idee e soluzioni che possano soddisfare ogni tipo di richiesta, ed è grazie a questo impegno che quest'anno siamo orgogliosi di presentare la ns. nuova sezione dedicata al CUSTOM MADE, il "**fatto su misura**". Solitamente ci proponiamo di creare soluzioni innovative adatte alle esigenze dei nostri singoli clienti per poi impostare una produzione in serie. L'obiettivo di questa nuova sezione è di offrire una soluzione alternativa mediante la creazione di maniglie uniche, studiate e pensate appositamente per i singoli mediante l'utilizzo di macchine a controllo numerico e lavorazione per le quali non è necessario sostenere i costi onerosi di uno stampo. Ci piace l'idea di essere in grado di fornire ai nostri clienti maniglie esclusive senza eguali che possano soddisfare appieno le loro esigenze estetiche e tecniche.

*The company **Fimet** has always stood for the constant search for ideas and solutions that can satisfy any kind of request, and it is through this commitment that this year we are proud to present our new section dedicated to "**CUSTOM MADE**". Usually we aim to create innovative solutions tailored to the needs of our individual customers and then set up a series production. The objective of this new section is to provide an alternative solution by creating unique handles, studied and designed specifically for the individual through the use of numerical control machines and manufacturing for which it is not necessary to support the high costs of a mould. We like the 'idea of being able to provide our customers with unmatched exclusive handles that can fully satisfy their aesthetic and technical requirements.*





INDICE CATALOGO - CATALOGUE INDEX

MANIGLIE SENZA TEMPO

LADY 148	8-9
FLORA 147P	10-11
FLORA 147	12-13
REGINA 105	14-15
VITTORIA 173	16-17
NINA 172	18-19
MICHELLE 106P	20-21
MICHELLE 106	22-23
WIEN 109	24-25
DOLL 142	26-27
MARINA 108	28-29
JULIETTE 152	30-31
PARIS 154	32-33
FALCE 192	34-35
WILD 157	36-37
EAGLE 150	38-39
DAMA 156	40-41
STONE 161S	42-43
SQUARE 160P	44-45
SWAROVSKI	46-47
PELLE - LEATHER	48-49

LINEAR

SABRINA 159	112-113
DANIELA 179	114-115
SILVIA 149	116-117
DIAMOND 199	118-119
GIORGIA 169	120-121
HORNET 145	122-123
KATE 122	124-125
GRACE 127	126-127
ANNE MARIE 197	128-129
RAINBOW 123	130-131
OLIMPIC 100	132-133
JOLIE 126	134-135
LIZA 121	136-137
FLY 130	138-139
SHADOW 120	140-141
EMILY 124	142-143
ARCH 113	144-145
FIONA 128	146-147
SOUBRETTE 115	148-149
DUCK 153	150-151
ECO LINE	152

ACCESSORI - ACCESSORIES 154-169

DESIGN

MIRAGE 125	52-53
MIRAGE 2 125-2	54-55
TOP 118	56-57
SOGNO 193	58-59
ALBA 140	60-61
HAVANA 139	62-63
STING 181	64-65
CLUB 110	66-67
QUEEN 180R	68-69
FLAG 180U	70-71
VENERE 186	72-73
DIANA 183	74-75
CORNER 114	76-77
CORNER 2 114-2	78-79
SOUND 184	80-81
BRIDGE 112	82-83
LINE 171	84-85
DOTS 170	86-87
WINTER 111	88-89
SPEAR 136	90-91

INOX

INOX 101	172
INOX 103	173
INOX 102	174
INOX 102 SQUARE	175
INOX 104	176
INOX 104 SQUARE	177
INOX 131	178
INOX 131 SQUARE	179
INOX 135	180
INOX 135 SQUARE	181
INOX 133	182
INOX 180	183
INOX 189 BIC	184
CLUB.ER 110ER	185
CORNER.ER 114ER	186
CORNER.ER 114ER SQUARE	187
CUBIC 102K SQUARE	188

ACCESSORI INOX
STAINLESS STEEL ACCESSORIES 190-199

SQUARE WORLD

SAETTA 175	94-95
HUMMER 165	96-97
ICE 168	98-99
CUT 164	100-101
SQUARE 160	102-103
SIN 166	104-105
BREAK 161	106-107
MANIGLIONI - PULL-HANDLES	108-109





MANIGLIE SENZA TEMPO

Le ns. MANIGLIE CLASSICHE che a noi piace chiamare "**timeless**"
rispecchiano gli stili architettonici del passato, con un tocco
di modernità dato dai materiali utilizzati e dalle finiture moderne
che si adattano ad ogni stile abitativo. Le nostre eleganti porcellane
sono di alta qualità, resistenti ai graffi, la loro lucentezza dura nel tempo
e sono costruite nel rispetto della natura.

*Our CLASSIC HANDLES that we like to call "**timeless**"
reflect the architectural styles of the past with a modern touch given by
the materials used and the modern finishes that fit any lifestyle.*

*Our elegant porcelain are of high quality, scratch resistant,
their luster lasts over time and are built in harmony with nature.*

Bianchi Vittore



MANIGLIE SENZA TEMPO



LADY 148





148/231C

Maniglia con rosetta
Handle with rosette

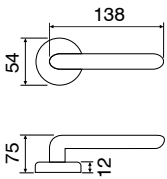

148/270

Maniglia con placca
Handle with plate

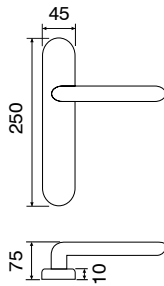

148 D.K.

Maniglia anta ribalta
Tilt and turn handle

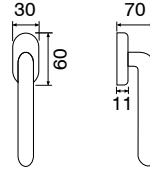

148STG/231C

Maniglione
Pull-handle

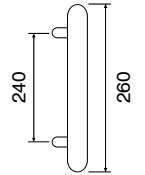

FINITURE - FINISHING



148/231C - F21 Silver stripes

Nikel lucido
Polish nickel



148/231C - F01 Gold stripes

Ottone lucido
Polish brass



148/231C - F45 Black stripes

Ferro antico
Antic iron



148/231C - F23 Sand

Bronzo antico
Aged bronzed brass



148/231C - F22 Black stripes

Peltro
Pewter



FLORA 147P





147P/250

Maniglia con rosetta
Handle with rosette

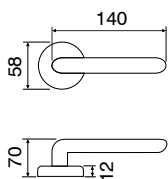

147P/280

Maniglia con placca
Handle with plate

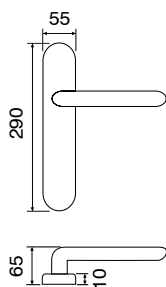

147P D.K.

Maniglia anta ribalta
Tilt and turn handle

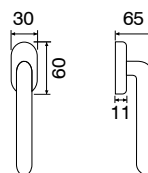

147P STG/250

Maniglione
Pull-handle

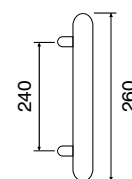

FINITURE - FINISHING



147P/231C F04 White/Silver

Cromo lucido
Polish chrome



147P/231C F01 White/Gold

Ottone lucido
Polish brass



147P/231C F04 Blue/Silver

Cromo lucido
Polish chrome



147P/231C F01 Blue/Gold

Ottone lucido
Polish brass

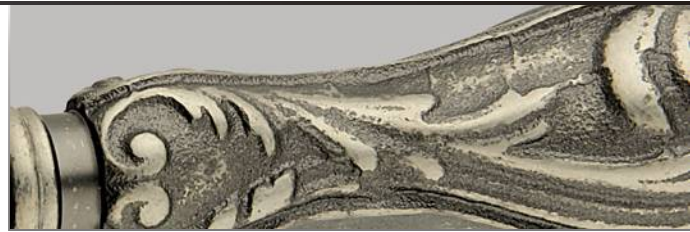



147/250

Maniglia con rosetta
Handle with rosette

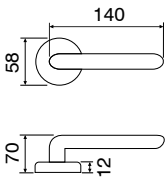

147/280

Maniglia con placca
Handle with plate

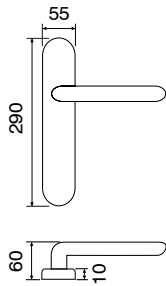

147 D.K.

Maniglia anta ribalta
Tilt and turn handle

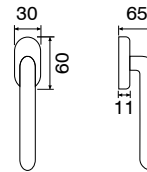

147STG/250

Maniglione
Pull-handle

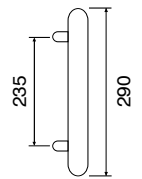

FINITURE - FINISHING



147/266 - F43

Bronzo satinato
Satin bronze



147/266 - F01

Ottone lucido
Polish brass



147/266 - F55

Bronzo chiaro - Bronzo scuro
Light Bronze - Dark bronze



147/266 - F21

Nikel lucido
Polish nickel



147/266 - F45

Ferro antico
Antic iron



REGINA 105





105/265

Maniglia con rosetta
Handle with rosette

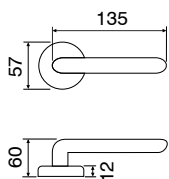

105/280

Maniglia con placca
Handle with plate

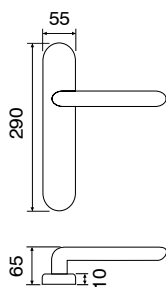

105 D.K.

Maniglia anta ribalta
Tilt and turn handle

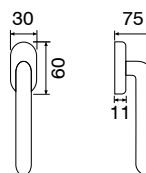

105 STG/265

Maniglione
Pull-handle

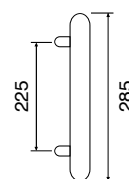

FINITURE - FINISHING



105/269 - F21

Nikel lucido
Polish nikel



105/269 - F43

Bronzo satinato
Satin bronze



105/269 - F02

Ottone satinato
Satin brass



105/269 - F45

Ferro antico
Antic iron



VITTORIA 173





173/265

Maniglia con rosetta
Handle with rosette

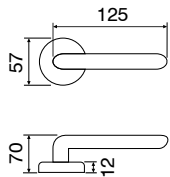

173/288

Maniglia con placca
Handle with plate

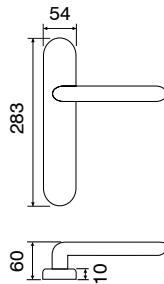

173 D.K.

Maniglia anta ribalta
Tilt and turn handle

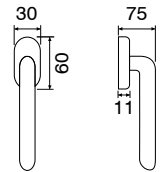

FINITURE - FINISHING



173/266 - F21

Nikel lucido
Polish nickel



173/266 - F43

Bronzo satinato
Satin bronze



173/266 - F02

Ottone satinato
Satin brass



173/266 - F45

Ferro antico
Antic iron



NINA 172

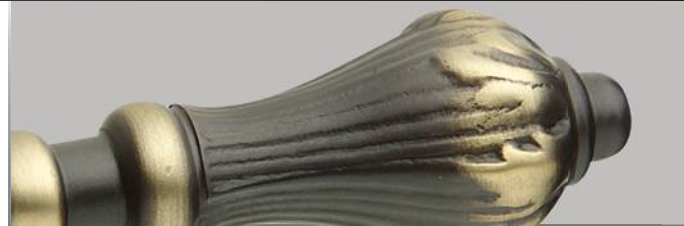



172/269

Maniglia con rosetta
Handle with rosette

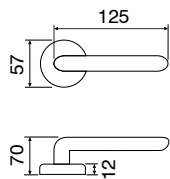

172/288

Maniglia con placca
Handle with plate

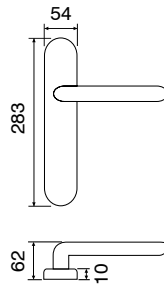

172 D.K.

Maniglia anta ribalta
Tilt and turn handle

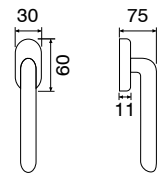

FINITURE - FINISHING



172/269 - F43

Bronzo satinato
Satin bronze



172/269 - F02

Ottone satinato
Satin brass



172/269 - F55

Bronzo chiaro - Bronzo scuro
Light bronze - Dark bronze



172/269 - F21

Nikel lucido
Polish nickel



172/269 - F45

Ferro antico
Antic iron



MICHELLE 106P

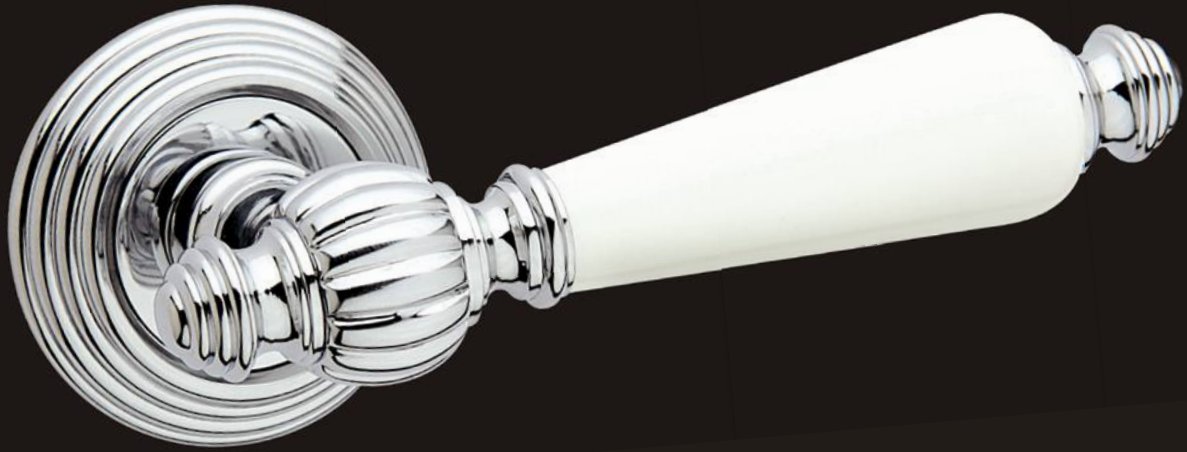



106P/269

Maniglia con rosetta
Handle with rosette

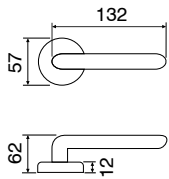

106P/288

Maniglia con placca
Handle with plate

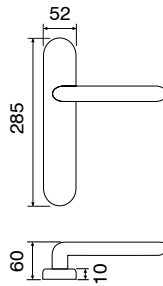

106P D.K.

Maniglia anta ribalta
Tilt and turn handle

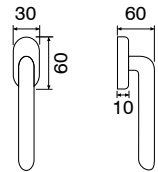

FINITURE - FINISHING



106P/269 - F04 White

Cromo lucido
Polish chrome



106P/269 - F21 Black

Nikel lucido
Polish nickel



106P/269 - F21 Flower

Nikel lucido
Polish nickel



106P/269 - F45 Beige

Ferro antico
Antic iron



106P/269 - F50 White

Bronzo scuro
Black bronze



MICHELLE 106





106/269

Maniglia con rosetta
Handle with rosette

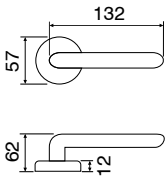

106/288

Maniglia con placca
Handle with plate

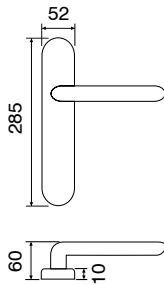

106 DK

Maniglia anta ribalta
Tilt and turn handle

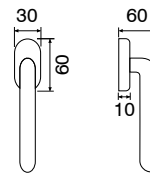

106 STG/269

Maniglione
Pull-handle

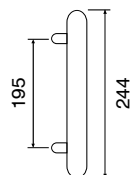

FINITURE - FINISHING



106/269 - F102

Argento/Pavè
Silver/Pavè



106/269 - F101

Oro/Pavè
Gold/Pavè



106/269 - F01

Ottone lucido
Polish brass



106/269 - F21

Nikel lucido
Polish nikel



106/269 - F21E

Nikel lucido - Ebano
Polish nikel - Ebony



106/269 - F43

Bronzo satinato
Satin Bronze



106/269 - F45

Ferro antico
Antic iron



106/269 - F99

Argento vecchio
Old silver





109/294

Maniglia con rosetta
Handle with rosette

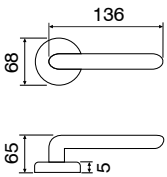

109/231B

Maniglia con rosetta
Handle with rosette

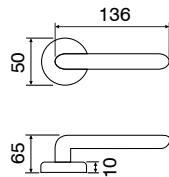

109/293

Maniglia con placca
Handle with plate

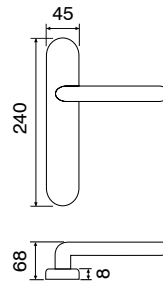

109 D.K.

Maniglia anta ribalta
Tilt and turn handle

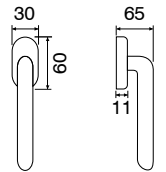

FINITURE - FINISHING



109/266 - F23

Bronzo antico
Aged bronzed brass



109/266 - F03

Ottone bronzato
Bronzed brass



109/266 - F43

Bronzo satinato
Satin bronze



109/266 - F01

Ottone lucido
Polish brass



109/266 - F21

Nikel lucido
Polish nickel



109/266 - F45

Ferro Antico
Antic iron



DOLL

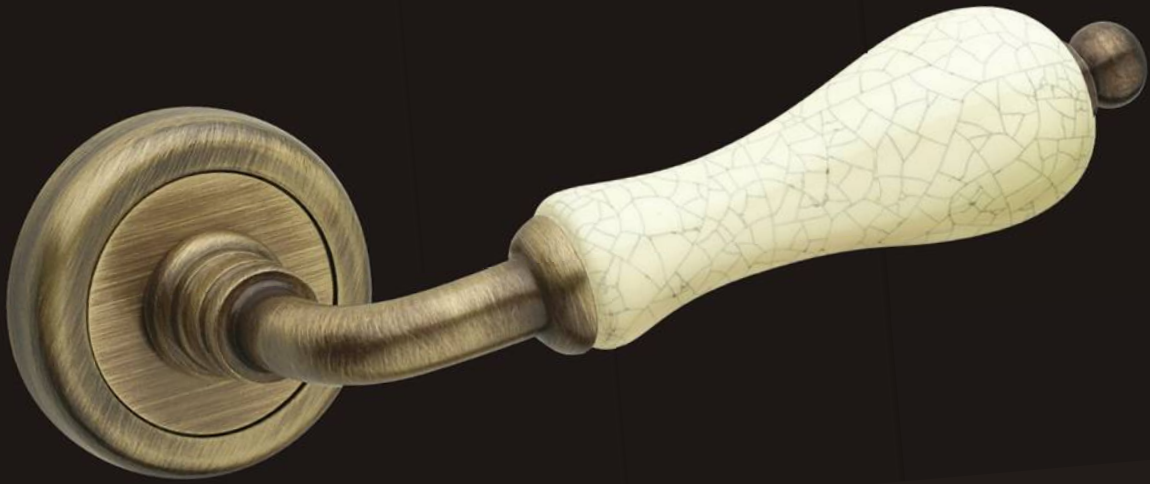

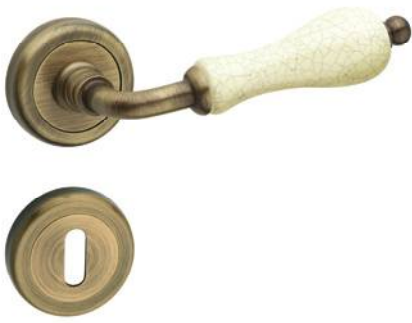

142/231B

Maniglia con rosetta
Handle with rosette

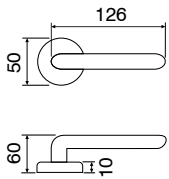

142/202

Maniglia con placca
Handle with plate

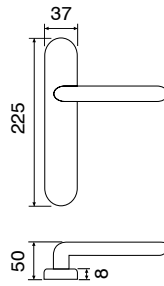

142 D.K.

Maniglia anta ribalta
Tilt and turn handle

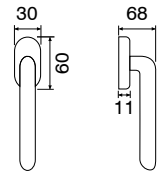

FINITURE - FINISHING



142/231B - F03 Crackle Beige

Ottone bronzato
Bronzed brass



141/231B - F03 White

Ottone bronzato
Bronzed brass



146/231B - F01 White Flower

Ottone lucido
Polish brass



143/231B - F03 Beige

Ottone bronzato
Bronzed brass



141/231B - F01 White

Ottone lucido
Polish brass



144/231B - F01 Beige Flower

Ottone lucido
Polish brass

MARINA 108





108/266

Maniglia con rosetta
Handle with rosette

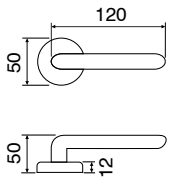

108/270

Maniglia con placca
Handle with plate

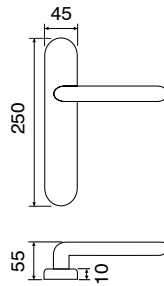

108 D.K.

Maniglia anta ribalta
Tilt and turn handle

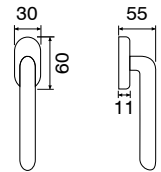

FINITURE - FINISHING



108/266 - F01 White

Ottone lucido
Polish brass



108/266 - F21 Black

Nikel lucido
Polish nickel



JULIETTE 152





152/231C

Maniglia con rosetta
Handle with rosette

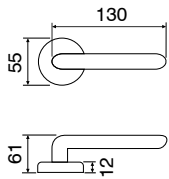

152/270

Maniglia con placca
Handle with plate

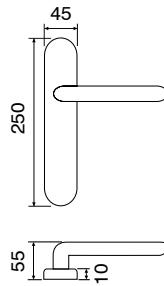

152 D.K.

Maniglia anta ribalta
Tilt and turn handle

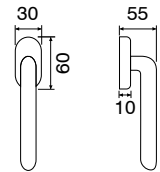

FINITURE - FINISHING



152/231C - F43

Bronzo satinato
Satin bronze



152/231C - F45

Ferro antico
Antic iron



152/231C - F01

Ottone lucido
Polish brass



152/231C - F21

Nikel lucido
Polish nickel

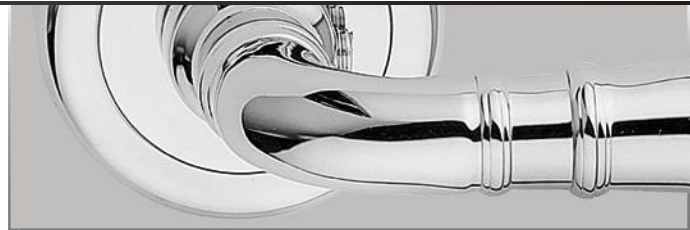



154/266

Maniglia con rosetta
Handle with rosette

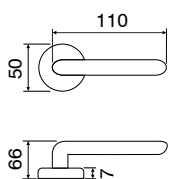

154/205

Maniglia con placca
Handle with plate

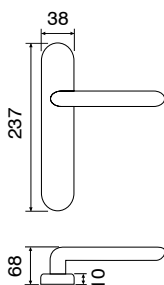

154 D.K.

Maniglia anta ribalta
Tilt and turn handle

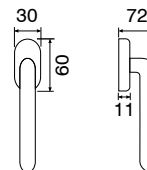

154 STG/266

Maniglione
Pull-handle

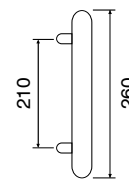

FINITURE - FINISHING



154/231B - F03

Ottone bronzato
Bronzed brass



154/231B - F23

Bronzo antico
Aged bronzed brass



154/231B - F45

Ferro Antico
Antic iron



154/231B - F43

Bronzo satinato
Satin bronze



154/231B - F01

Ottone lucido
Polish brass



154/231B - F04

Cromo lucido
Polish chrome

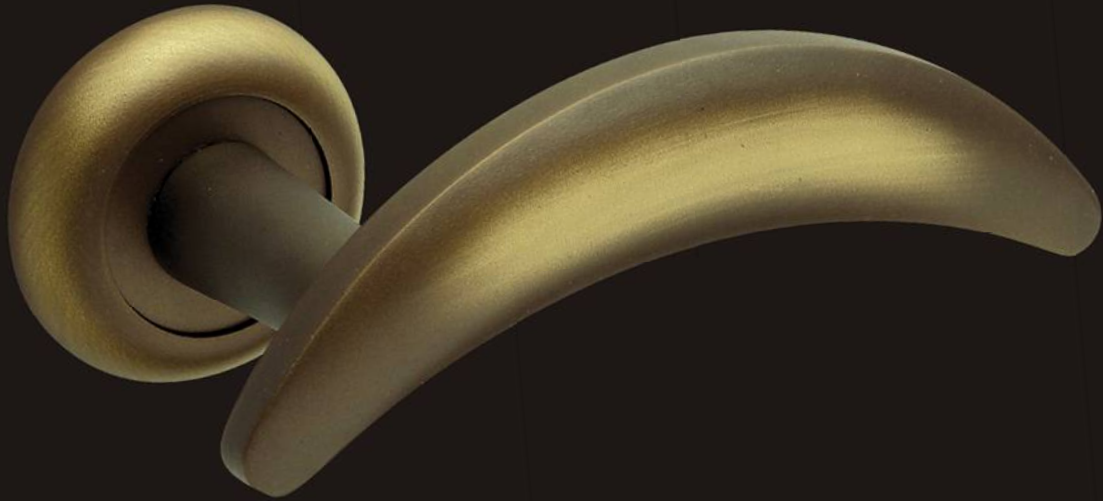



192/231C

Maniglia con rosetta
Handle with rosette

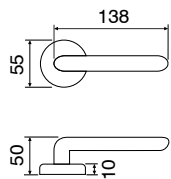

192/270

Maniglia con placca
Handle with plate

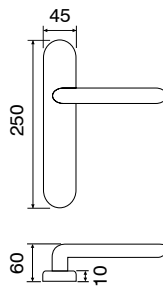

192 D.K.

Maniglia anta ribalta
Tilt and turn handle

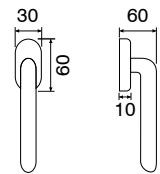

FINITURE - FINISHING



192/231C - F55

Bronzo chiaro - Bronzo scuro
Light bronze - Dark bronze



192/231C - F43

Bronzo satinato
Satin bronze



192/231C - F50

Bronzo scuro
Dark bronze



192/231C - F01

Ottone lucido
Polish brass



192/231C - F05

Cromo satinato
Satin chrome





157/231C

Maniglia con rosetta
Handle with rosette

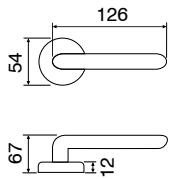

157/270

Maniglia con placca
Handle with plate

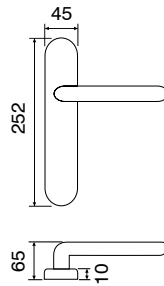

157 D.K.

Maniglia anta ribalta
Tilt and turn handle

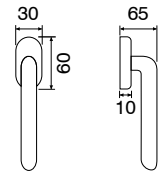

FINITURE - FINISHING



157/231C - F01

Ottone lucido
Polish brass



157/231C - F04

Cromo lucido
Polish chrome



157/231C - F05

Cromo satinato
Satin chrome

 EAGLE 150

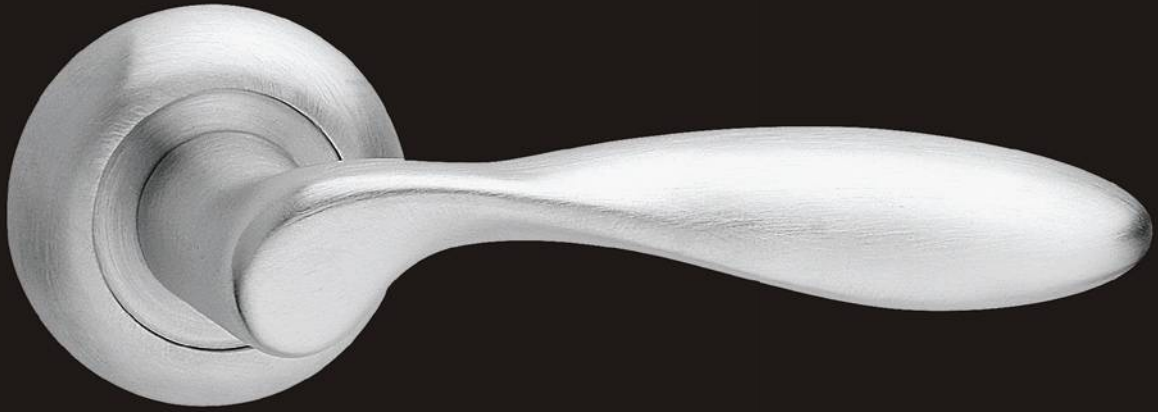



150/231C

Maniglia con rosetta
Handle with rosette

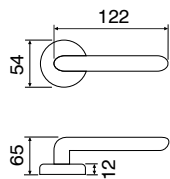

150/270

Maniglia con placca
Handle with plate

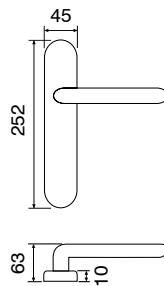

150 D.K.

Maniglia anta ribalta
Tilt and turn handle

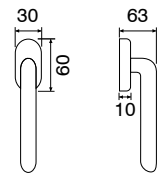

FINITURE - FINISHING



150/231C - F01

Ottone lucido
Polish brass



150/231C - F04

Cromo lucido
Polish chrome



150/231C - F05

Cromo satinato
Satin chrome





156/231C

Maniglia con rosetta
Handle with rosette

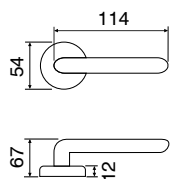

156/235

Maniglia con placca
Handle with plate

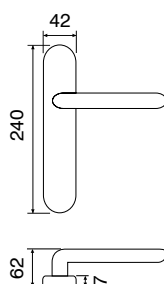

326/231C

Pomolo con rosetta
Door - Knob with rosette



FINITURE - FINISHING



156/231C - F01

Ottone lucido
Polish brass



156/231C - F55

Bronzo chiaro - Bronzo scuro
Light bronze - Dark bronze



156/231C - F04

Cromo lucido
Polish chrome



STONE 161S





161S/211BIC

Maniglia con rosetta
Handle with rosette

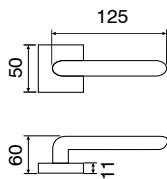

161S/2110

Maniglia con placca
Handle with plate

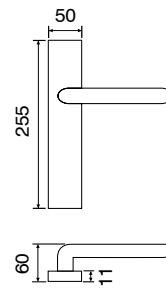

FINITURE - FINISHING



161S/211BIC - F04 White

Cromo lucido
Polish chrome



161S/211BIC - F45 Grey

Ferro antico
Antic iron



161S/211BIC - F01 Honey

Ottone lucido
Polish brass



161S/211BIC - F03 Honey

Bronzo graffiato lucido
Bronze brillant satin



SQUARE P 160P

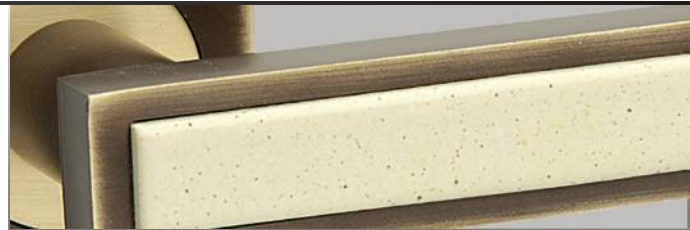
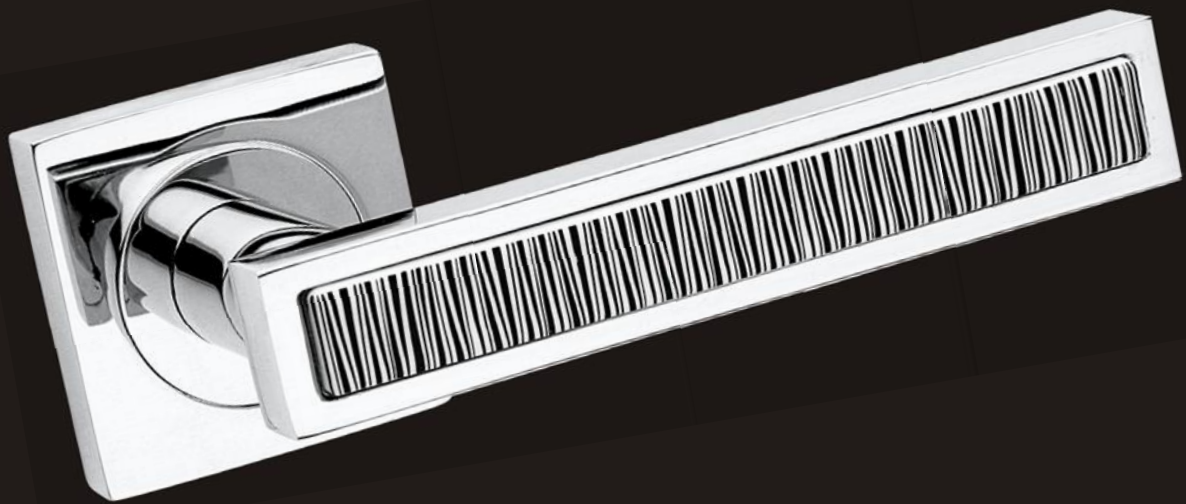



160P/211BIC

Maniglia con rosetta
Handle with rosette

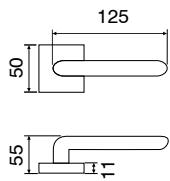

160P/210

Maniglia con placca
Handle with plate

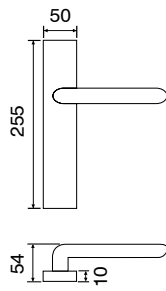

160P D.K.R.

Maniglia anta ribalta
Tilt and turn handle

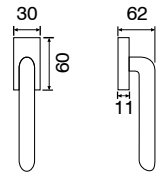

FINITURE - FINISHING



160P/211BIC - F04 Zebra

Cromo lucido
Polish chrome



160P/211BIC - F04 White

Cromo lucido
Polish chrome



160P/211BIC - F45 White

Ferro antico
Antic iron



160P/211BIC - F21 Black

Nikel lucido
Polish nickel



160P/211BIC - F55 Sand

Bronzo chiaro - Bronzo scuro
Light bronze - Dark bronze

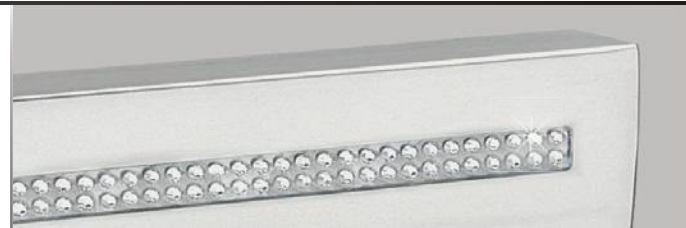
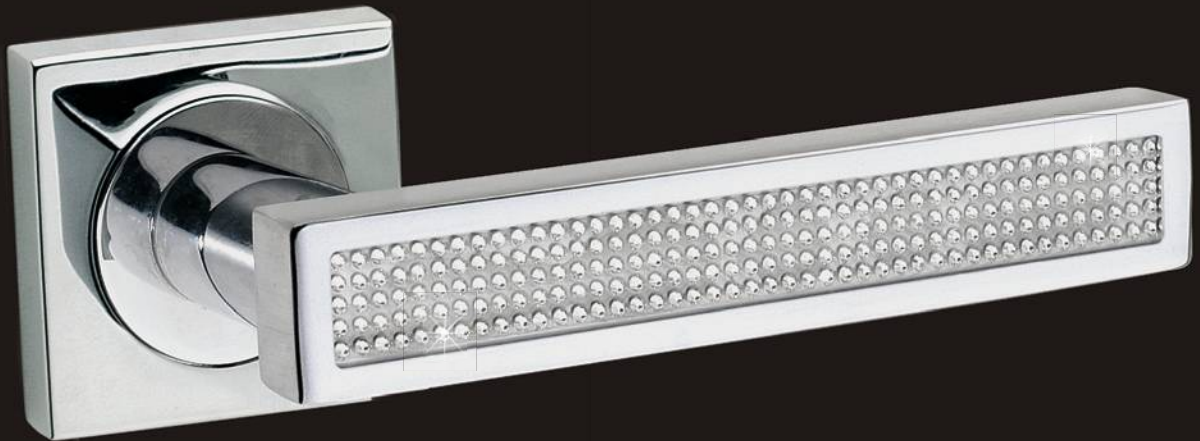

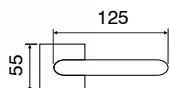

160S.1/211BIC - F04S

Cromo lucido/Swarovski
Polish chrome/Swarovski

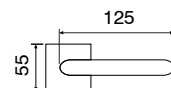
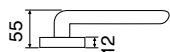

160S.3/211BIC - F04S

Cromo lucido/Swarovski
Polish chrome/Swarovski

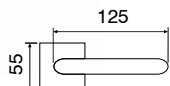
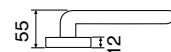

160S.2/211BIC - F04S

Cromo lucido/Swarovski
Polish chrome/Swarovski

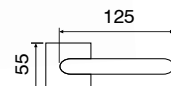
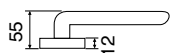

164F/211BIC - F04S

Cromo lucido/Swarovski
Polish chrome/Swarovski

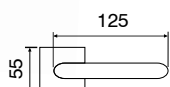
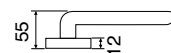

164F/211BIC - F55S

Bronzo/Swarovski
Bronze/Swarovski

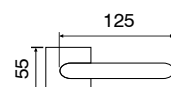
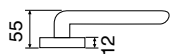

160S.2/211BIC - F55S

Bronzo/Swarovski
Bronze/Swarovski

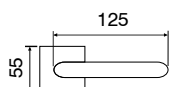

160S.3/211BIC - F55S

Bronzo/Swarovski
Bronze/Swarovski

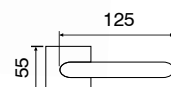
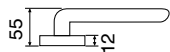

160S.1/211BIC - F55S

Bronzo/Swarovski
Bronze/Swarovski







112/231B - F04 Bordeaux

Cromo lucido
Polish chrome

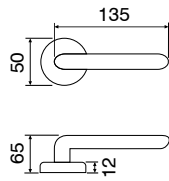

112/211BIC - F04 Black

Cromo lucido
Polish chrome

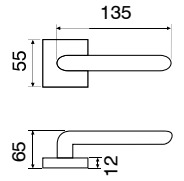

193/231C - F04 Black

Cromo lucido
Polish chrome

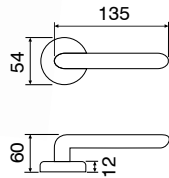

193/231C - F01 Cuoio

Ottone lucido
Polish brass

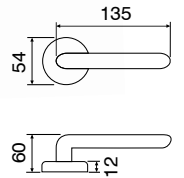

160.3 - 211BIC F04 Black

Cromo lucido
Polish chrome

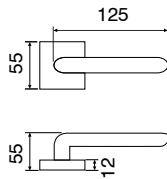

160.3 - 211BIC F04 Cuoio

Cromo lucido
Polish chrome

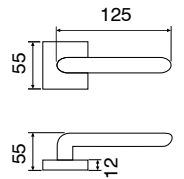

160.3 - 211BIC F04 Testa di moro

Cromo lucido
Polish chrome

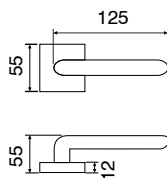

160.3 - 211BIC F04 Bianco

Cromo lucido
Polish chrome

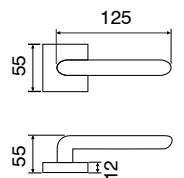



DESIGN

La nostra gamma DESIGN MANIGLIE
dalle linee essenziali, moderne e semplici
che regalano un tocco di eleganza.

Our DESIGN RANGE.

*Handles with clean and modern lines,
simple with an elegant touch.*

Bianchi Vittore

A handwritten signature in black ink that reads "Bianchi Vittore".



DESIGN



MIRAGE 125





125/231

Maniglia con rosetta
Handle with rosette

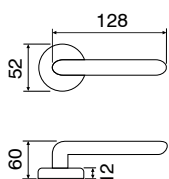

125/275

Maniglia con placca
Handle with plate

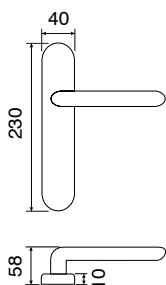

118 D.K.

Maniglia anta ribalta
Tilt and turn handle

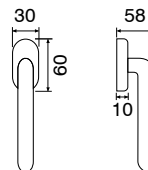

125 STG/231

Maniglione
Pull-handle

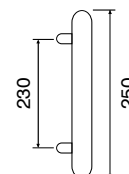

FINITURE - FINISHING



125/231 - F10

Ottone lucido - Ottone satinato
Polish brass - Satin brass



125/231 - F64

Ottone lucido - Inox satinato
Polish brass - Satin steel



125/231 - F65

Cromo lucido - Inox satinato
Polish chrome - Satin steel



MIRAGE 2 125-2





125-2/231

Maniglia con rosetta
Handle with rosette

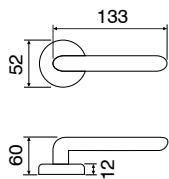

125-2/275

Maniglia con placca
Handle with plate

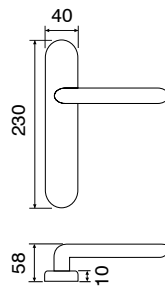

118 D.K.

Maniglia anta ribalta
Tilt and turn handle

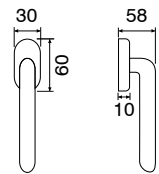

FINITURE - FINISHING



125-2/231 - F65

Cromo lucido - Inox satinato
Polish chrome - Satin steel





118/236

Maniglia con rosetta
Handle with rosette

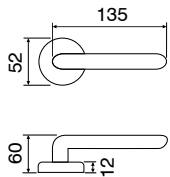

118/275

Maniglia con placca
Handle with plate

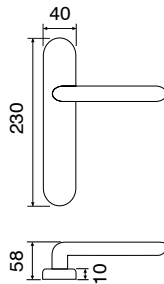

118 D.K.

Maniglia anta ribalta
Tilt and turn handle

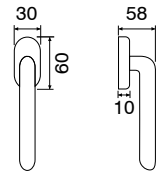

FINITURE - FINISHING



118/230 - F10

Ottone lucido - Ottone satinato
Polish brass - Satin brass



118/230 - F64

Ottone lucido - Inox satinato
Polish brass - Satin steel



118/236 - F65

Cromo lucido - Inox satinato
Polish chrome - Satin steel



SOGNO 193





193/231C

Maniglia con rosetta
Handle with rosette

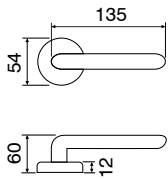

193/275

Maniglia con placca
Handle with plate

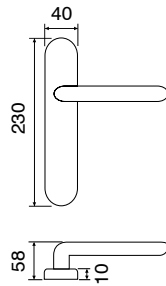

193 D.K.

Maniglia anta ribalta
Tilt and turn handle

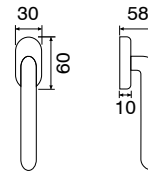

139 STG/231C

Maniglione
Pull-handle

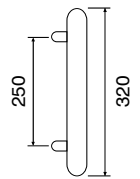

FINITURE - FINISHING



193/231C - F10

Ottone lucido - Ottone satinato
Polish brass - Satin brass



193/231C - F11

Cromo lucido - Nickel satinato
Polish chrome - Satin nickel



193/231C - F66

Cromo lucido - Cromo satinato
Polish chrome - Satin chrome



ALBA 140

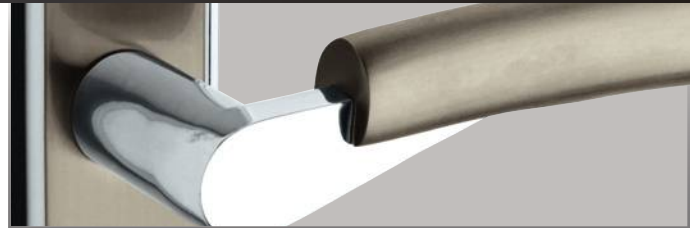



140/230R

Maniglia con rosetta
Handle with rosette

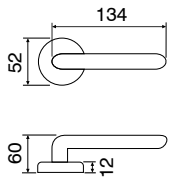

140/275

Maniglia con placca
Handle with plate

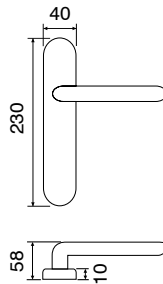

140 D.K.

Maniglia anta ribalta
Tilt and turn handle

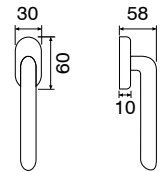

FINITURE - FINISHING



140/230R - F10

Ottone lucido - Ottone satinato
Polish brass - Satin brass



140/230R - F11

Cromo lucido - Nickel satinato
Polish chrome - Satin nickel



140/230R - F66

Cromo lucido - Cromo satinato
Polish chrome - Satin chrome



HAVANA 139





139/231C

Maniglia con rosetta
Handle with rosette

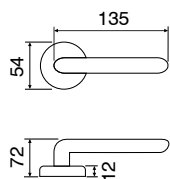

139/275

Maniglia con placca
Handle with plate

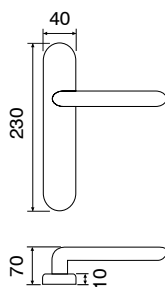

139 D.K.

Maniglia anta ribalta
Tilt and turn handle

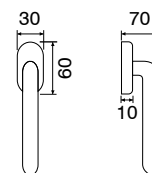

FINITURE - FINISHING



139/231C - F10

Ottone lucido - Ottone satinato
Polish brass - Satin brass



139/231C - F11

Cromo lucido - Nickel satinato
Polish chrome - Satin nickel



139/231C - F66

Cromo lucido - Cromo satinato
Polish chrome - Satin chrome



STING 181

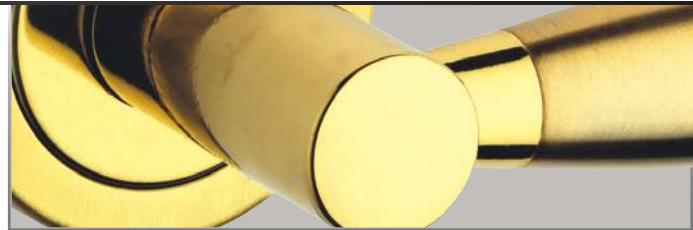
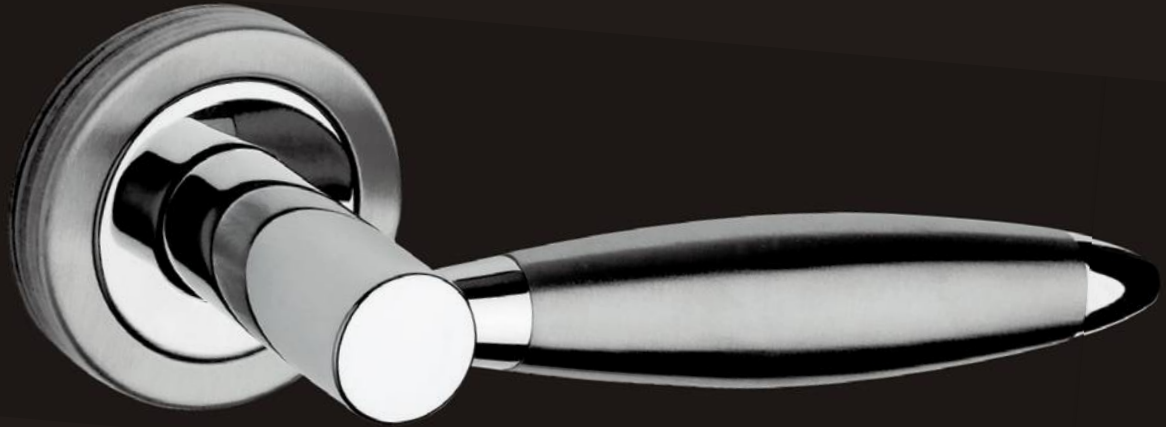

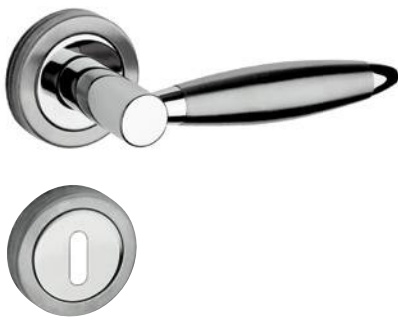

181/231

Maniglia con rosetta
Handle with rosette

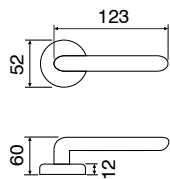

181/270

Maniglia con placca
Handle with plate

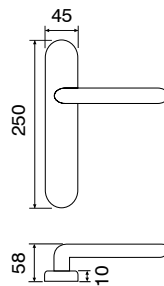

181 D.K.

Maniglia anta ribalta
Tilt and turn handle

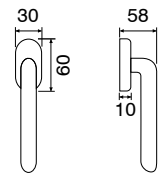

FINITURE - FINISHING



181/231 - F10

Ottone lucido - Ottone satinato
Polish brass - Satin brass



181/231 - F65

Cromo lucido - Inox satinato
Polish chrome - Satin steel



181/231 - F64

Ottone lucido - Inox satinato
Polish brass - Satin steel



CLUB 110

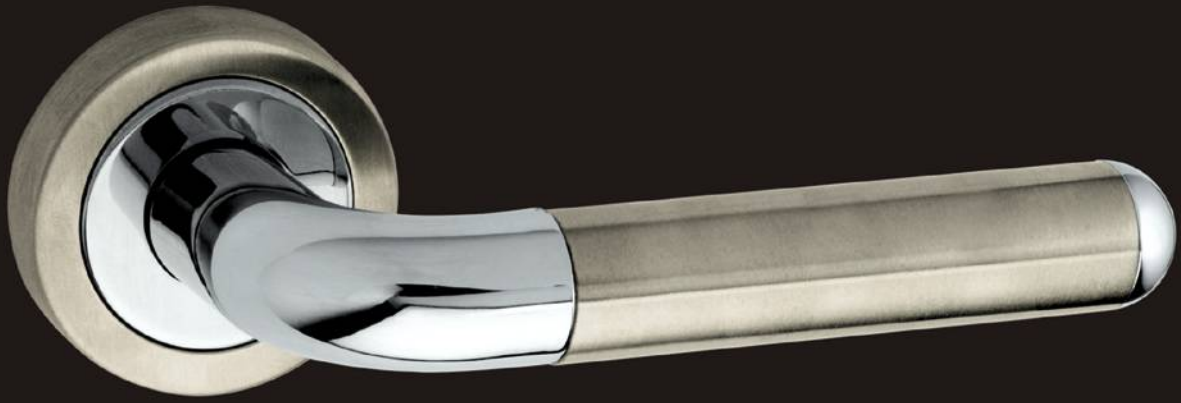



110/231

Maniglia con rosetta
Handle with rosette

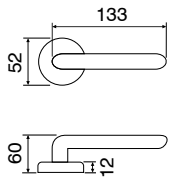

110/275

Maniglia con placca
Handle with plate

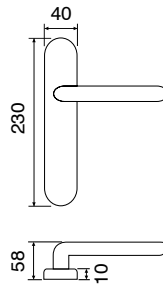

110/277

Maniglia con rosetta ovale
Handle with oval rosette

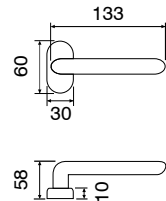

FINITURE - FINISHING



110/231 - F08

Ottone lucido - Cromo lucido
Polish brass - Chrome



110/231 - F10

Ottone lucido - Ottone satinato
Polish brass - Satin brass



110/231 - F64

Ottone lucido - Inox satinato
Polish brass - Satin steel



110/231 - F65

Cromo lucido - Inox satinato
Polish chrome - Satin steel



110/231 - F87

Cromo lucido - Faggio
Polish chrome - Beechwood



QUEEN 180R

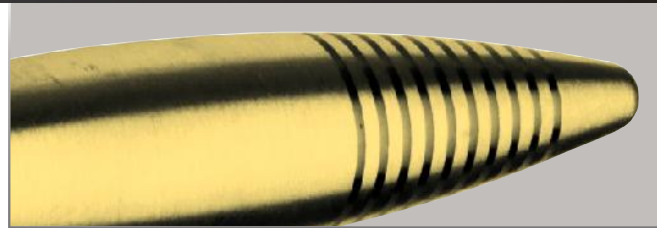



180R/231C

Maniglia con rosetta
Handle with rosette

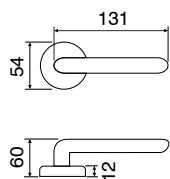

180R/270

Maniglia con placca
Handle with plate

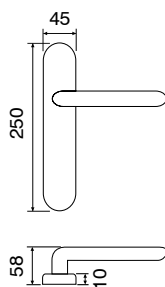

180R D.K.

Maniglia anta ribalta
Tilt and turn handle

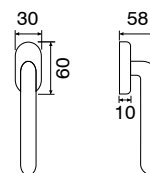

FINITURE - FINISHING



180R/231C - F10

Ottone lucido - Ottone satinato
Polish brass - Satin brass



180R/231C - F66

Cromo lucido - Cromo satinato
Polish chrome - Satin chrome



FLAG 180U

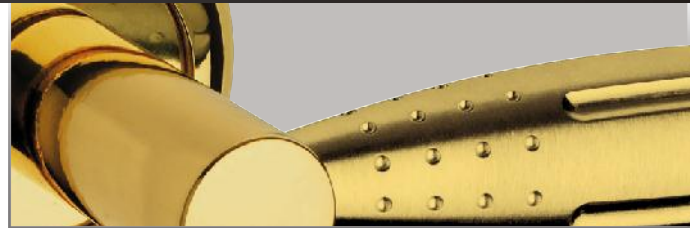
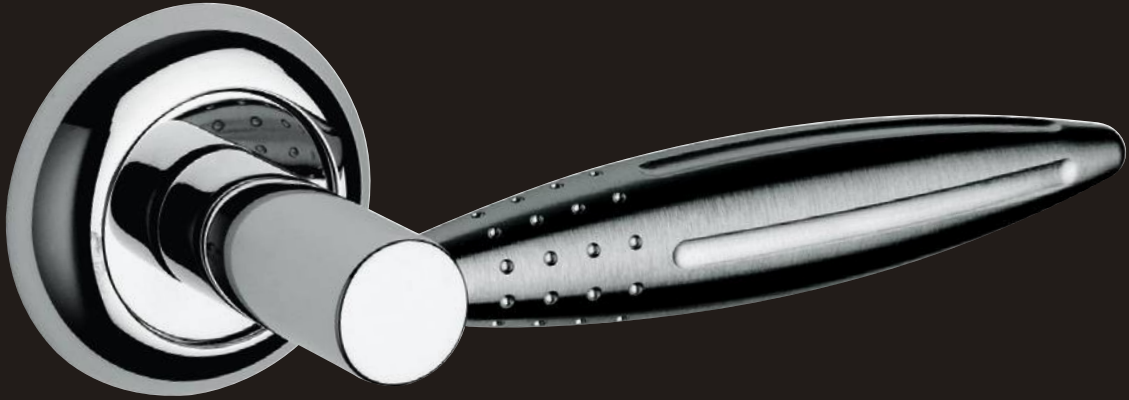



180U/231C

Maniglia con rosetta
Handle with rosette

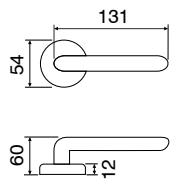

180U/270

Maniglia con placca
Handle with plate

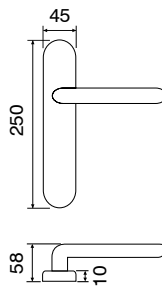

180U D.K.

Maniglia anta ribalta
Tilt and turn handle

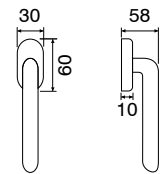

FINITURE - FINISHING



180U/231C - F10

Ottone lucido - Ottone satinato
Polish brass - Satin brass



180U/231C - F66

Cromo lucido - Cromo satinato
Polish chrome - Satin chrome



VENERE 186





186/231B

Maniglia con rosetta
Handle with rosette

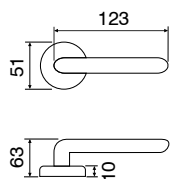

186/270

Maniglia con placca
Handle with plate

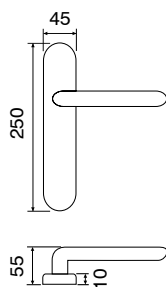

186 D.K.

Maniglia anta ribalta
Tilt and turn handle

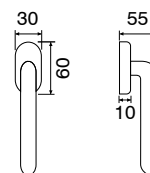

FINITURE - FINISHING



186/231B - F66

Cromo lucido - Cromo satinato
Polish chrome - Satin chrome



DIANA 183

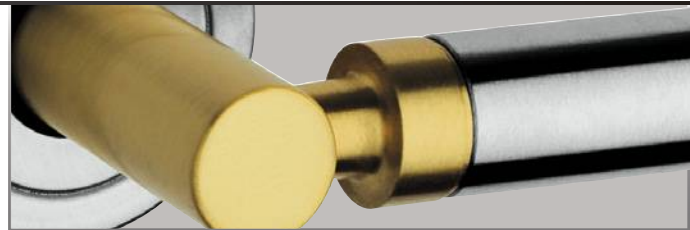



183/231

Maniglia con rosetta
Handle with rosette

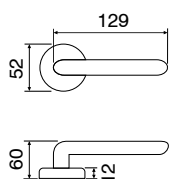

183/270

Maniglia con placca
Handle with plate

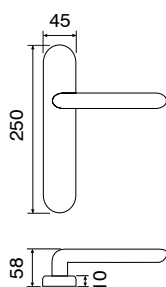

183 D.K.

Maniglia anta ribalta
Tilt and turn handle

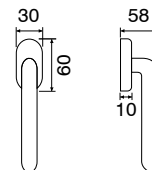

FINITURE - FINISHING



183/231 - F65

Cromo lucido - Inox satinato
Polish chrome - Satin steel



183/230R - F62

Ottone satinato - Inox satinato
Satin brass - Satin steel



CORNER 114





114/231

Maniglia con rosetta
Handle with rosette

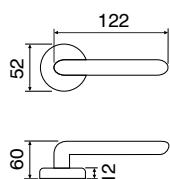

114/275

Maniglia con placca
Handle with plate

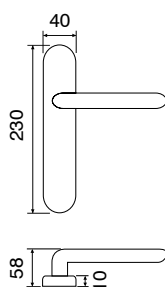

114 D.K.

Maniglia anta ribalta
Tilt and turn handle

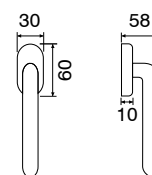

FINITURE - FINISHING



114/231 - F64

Ottone lucido - Inox satinato
Polish brass - Satin steel



114/231 - F87

Cromo lucido - Faggio
Polish chrome - Beechwood



114/231 - F65

Cromo lucido - Inox satinato
Polish chrome - Satin steel



CORNER 2 114-2

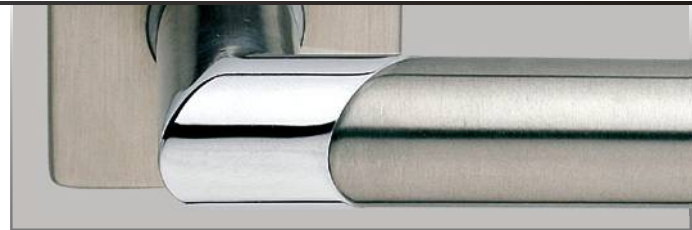



114-2/231

Maniglia con rosetta
Handle with rosette

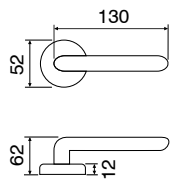

114-2/275

Maniglia con placca
Handle with plate

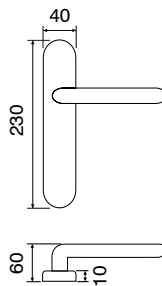

114-2 D.K.

Maniglia anta ribalta
Tilt and turn handle

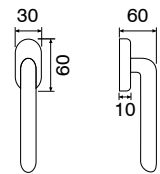

FINITURE - FINISHING



114-2/211B - F65

Cromo lucido - Inox satinato
Polish chrome - Satin steel



114-2/231 - F65

Cromo lucido - Inox satinato
Polish chrome - Satin steel



SOUND 184





184/231

Maniglia con rosetta
Handle with rosette

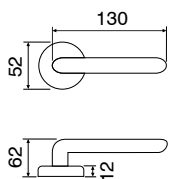

184/275

Maniglia con placca
Handle with plate

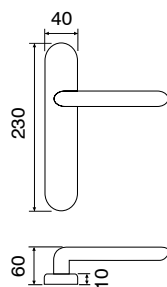

184 D.K.

Maniglia anta ribalta
Tilt and turn handle

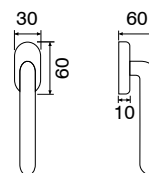

184 STG/231

Maniglione
Pull-handle

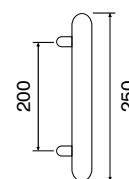

FINITURE - FINISHING



184/231 - F11

Cromo lucido - Nikel satinato
Polish chrome - Satin nickel



184/231 - F12

Ottone lucido - Nikel satinato
Polish brass - Satin nickel

BRIDGE 112





112/231

Maniglia con rosetta
Handle with rosette

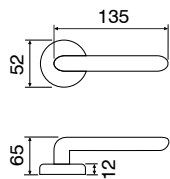

112/275

Maniglia con placca
Handle with plate

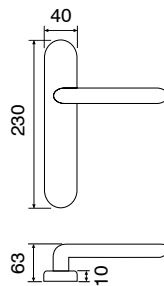

112 D.K.

Maniglia anta ribalta
Tilt and turn handle

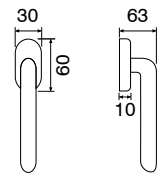

FINITURE - FINISHING



112/231 - F11

Cromo lucido - Nikel satinato
Polish chrome - Satin nickel



112/231 - F66

Cromo lucido - Cromo satinato
Polish chrome - Satin chrome

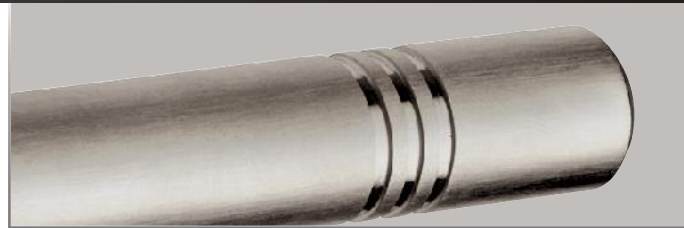



171/230R

Maniglia con rosetta
Handle with rosette

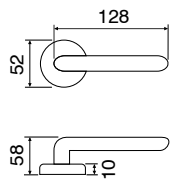

171/202

Maniglia con placca
Handle with plate

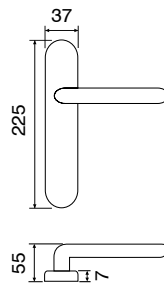

171 D.K.

Maniglia anta ribalta
Tilt and turn handle

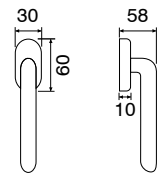

FINITURE - FINISHING



171/230R - F05

Cromo satinato
Satin chrome



171/230R - F20

Nikel satinato
Satin nickel



DOTS 170

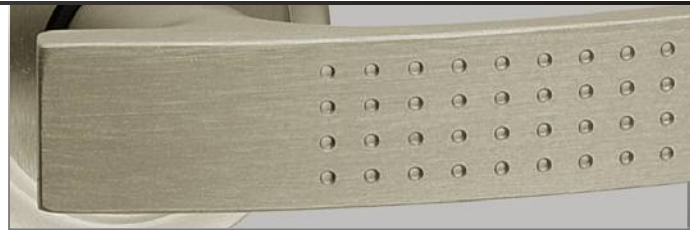
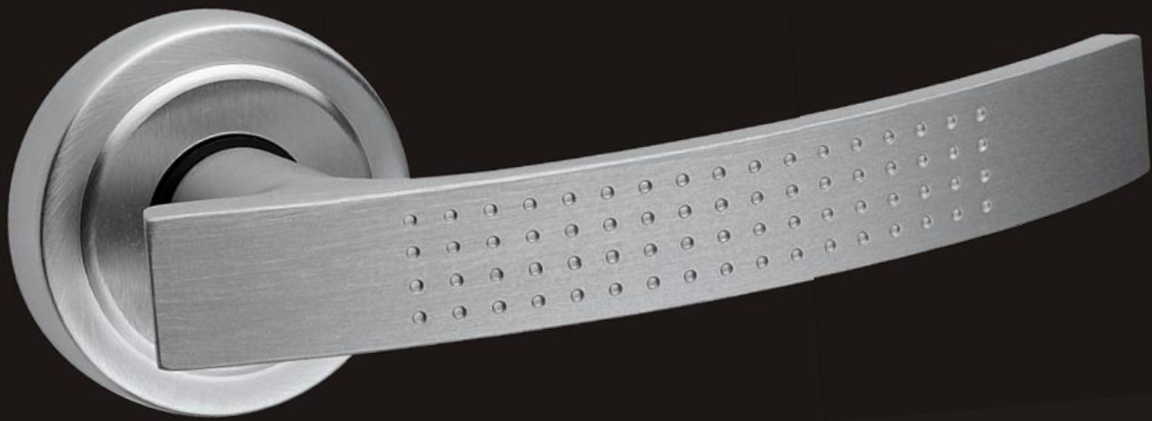



170/230R

Maniglia con rosetta
Handle with rosette

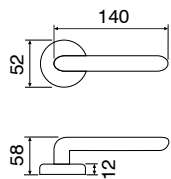

170/277

Maniglia con rosetta ovale
Handle with oval rosette

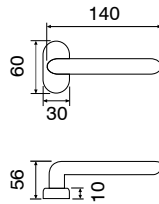

170 D.K.

Maniglia anta ribalta
Tilt and turn handle

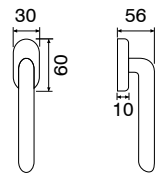

FINITURE - FINISHING



170/230R - F20

Nikel satinato
Satin nickel



170/230R - F05

Cromo satinato
Satin chrome



WINTER 111





111/211B

Maniglia con rosetta
Handle with rosette

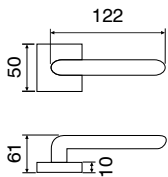

111/212

Maniglia con placca
Handle with plate

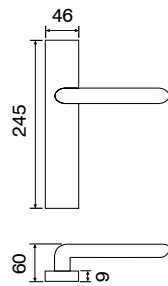

111 D.K.R.

Maniglia anta ribalta
Tilt and turn handle

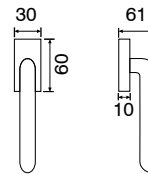

111 STG/211B

Maniglione
Pull-handle

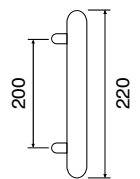

FINITURE - FINISHING



111/211B - F63

Inox satinato - Inox lucido
Satin steel - Polish steel



111/231 - F63

Inox satinato - Inox lucido
Satin steel - Polish steel



SPEAR 136

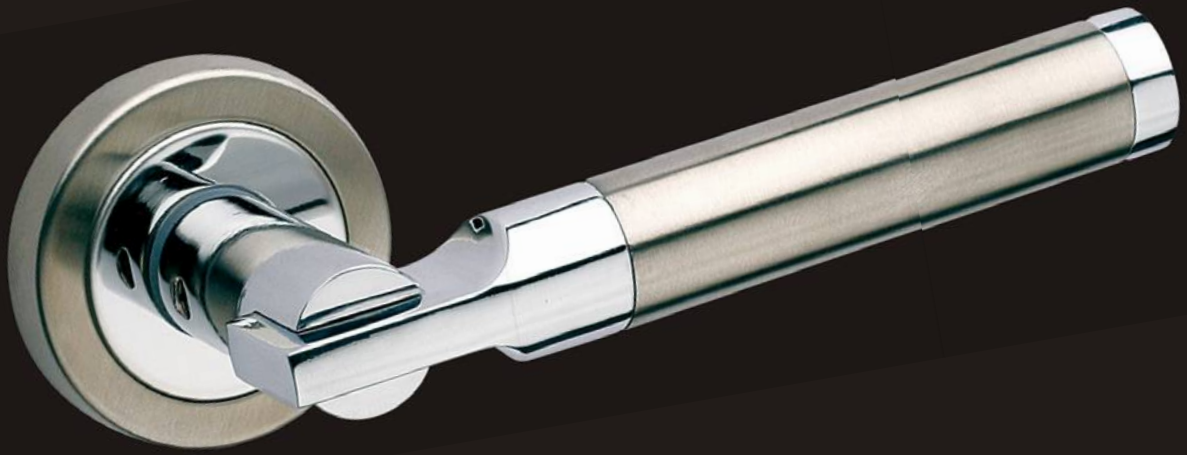



136/231

Maniglia con rosetta
Handle with rosette

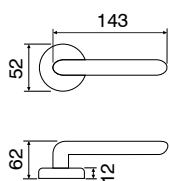

136/275

Maniglia con placca
Handle with plate

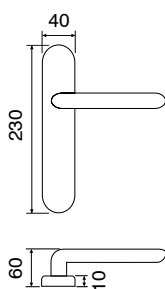

136 D.K.

Maniglia anta ribalta
Tilt and turn handle

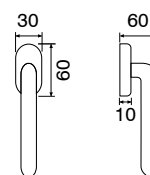

FINITURE - FINISHING



136/231 - F65

Cromo lucido - Inox satinato
Polish chrome - Satin steel



SQUARE WORLD

le nostre MANIGLIE SQUARE sono maniglie moderne
perfette per lo stile attuale tendente alla semplicità
e alla funzionalità nel design.

*Our SQUARE HANDLES are modern,
perfect for the actual style tending
to simplicity and functionality*

Bianchi Vittore



SQUARE WORLD



SAETTA 175

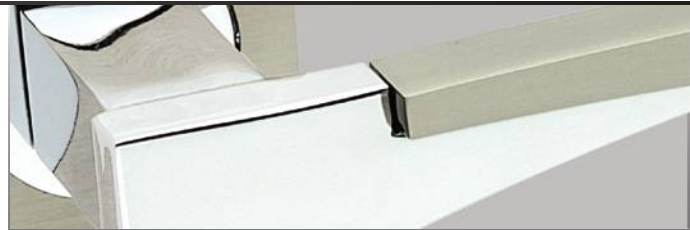



175/211BIC

Maniglia con rosetta
Handle with rosette

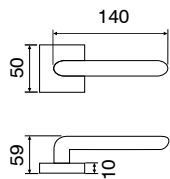

175/210

Maniglia con placca
Handle with plate

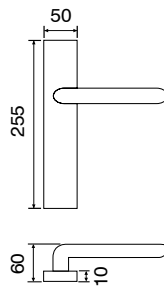

175 D.K.R.

Maniglia anta ribalta
Tilt and turn handle

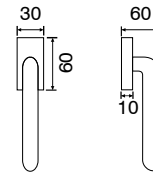

FINITURE - FINISHING



175/211BIC - F66

Cromo lucido - Cromo satinato
Polish chrome - Satin chrome



175/211BIC - F11

Cromo lucido - Nikel satinato
Polish chrome - Satin nickel



HUMMER 165





165/211BIC

Maniglia con rosetta
Handle with rosette

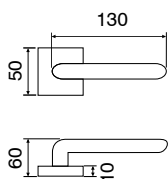

165/212

Maniglia con placca
Handle with plate

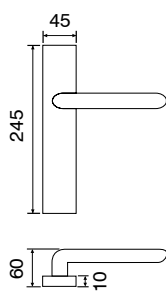

165 D.K.R.

Maniglia anta ribalta
Tilt and turn handle

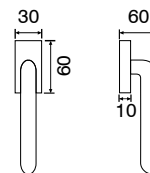

FINITURE - FINISHING



165/211BIC - F11

Cromo lucido - Nikel satinato
Polish chrome - Satin nickel



165/211BIC - F66

Cromo lucido - Cromo satinato
Polish chrome - Satin chrome



165/211BIC - F10

Ottone lucido - Ottone satinato
Polished brass - Satin brass



165/211BIC - F43

Bronzo satinato
Satin bronze





168/211BIC

Maniglia con rosetta
Handle with rosette

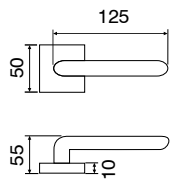

168/210

Maniglia con placca
Handle with plate

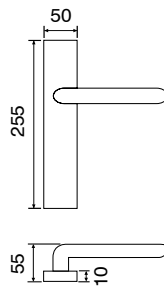

168 D.K.R.

Maniglia anta ribalta
Tilt and turn handle

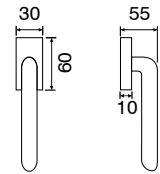

FINITURE - FINISHING



168/211BIC - F04

Cromo lucido
Polish chrome



168/211BIC - F05

Cromo satinato
Satin chrome



168/211BIC - F66

Cromo lucido - Cromo satinato
Polish chrome - Satin chrome



168/211BIC - F43

Bronzo satinato
Satin bronze





164/211BIC

Maniglia con rosetta
Handle with rosette

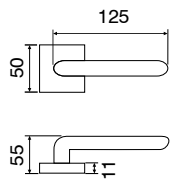

164/210

Maniglia con placca
Handle with plate

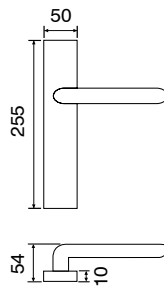

164 D.K.R.

Maniglia anta ribalta
Tilt and turn handle

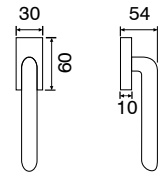

FINITURE - FINISHING



164/211BIC - F11

Cromo lucido - Nikel satinato
Polish chrome - Satin nikel



164/211BIC - F66

Cromo lucido - Cromo satinato
Polish chrome - Satin chrome



164/211BIC - F43

Bronzo satinato
Satin Bronze



SQUARE 160





160/211BIC

Maniglia con rosetta
Handle with rosette

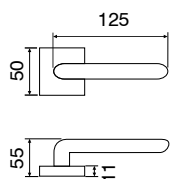

160/210

Maniglia con placca
Handle with plate

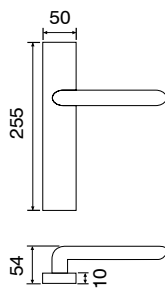

160 D.K.R.

Maniglia anta ribalta
Tilt and turn handle

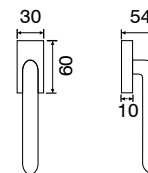

FINITURE - FINISHING



160/211BIC - F11

Cromo lucido - Nikel satinato
Polish chrome - Satin nickel



160/211BIC - F66

Cromo lucido - Cromo satinato
Polish chrome - Satin chrome



160W/211BIC - F11PVD

Cromo lucido - Nikel satinato + Legno
Polish chrome - Satin nickel + Wood



160W/211BIC - F55

Bronzo chiaro - Bronzo scuro + Legno
Light bronze - Dark bronze + Wood

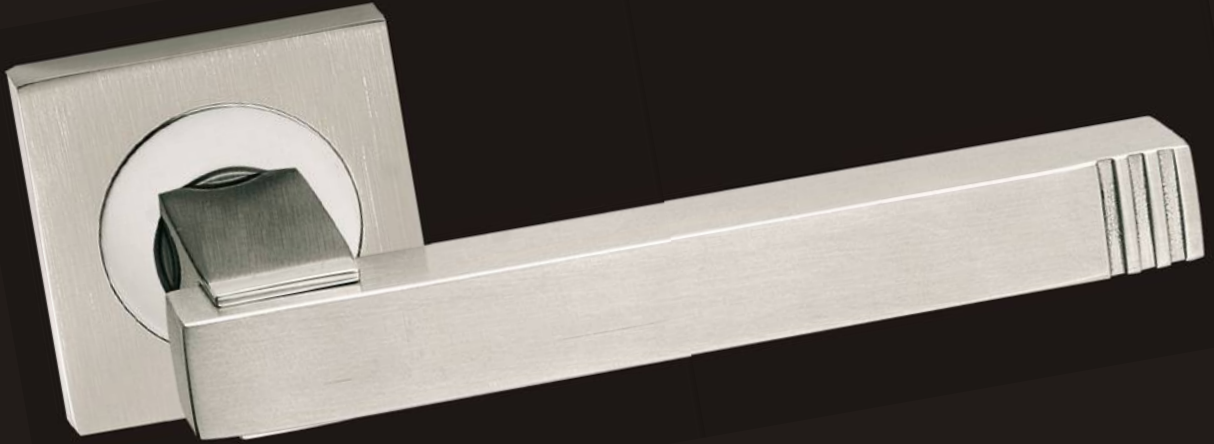



166/211BIC

Maniglia con rosetta
Handle with rosette

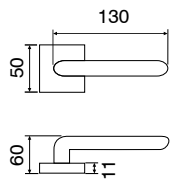

166/2110

Maniglia con placca
Handle with plate

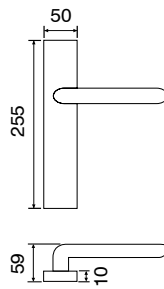

166 D.K.R.

Maniglia anta ribalta
Tilt and turn handle

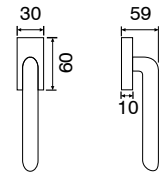

FINITURE - FINISHING



166/211BIC - F11

Cromo lucido - Nikel satinato
Polish chrome - Satin nickel



166/211BIC - F66

Cromo lucido - Cromo satinato
Polish chrome - Satin chrome





161/211BIC

Maniglia con rosetta
Handle with rosette

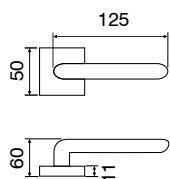

161/210

Maniglia con placca
Handle with plate

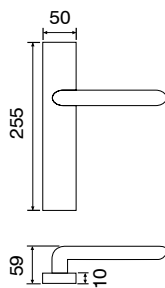

164 D.K.R.

Maniglia anta ribalta
Tilt and turn handle

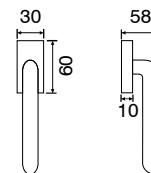

FINITURE - FINISHING



161/211BIC - F11

Cromo lucido - Nikel satinato
Polish chrome - Satin nickel



161/211BIC - F66

Cromo lucido - Cromo satinato
Polish chrome - Satin chrome



161/211BIC - F55

Bronzo chiaro - Bronzo scuro
Light bronze - Dark bronze

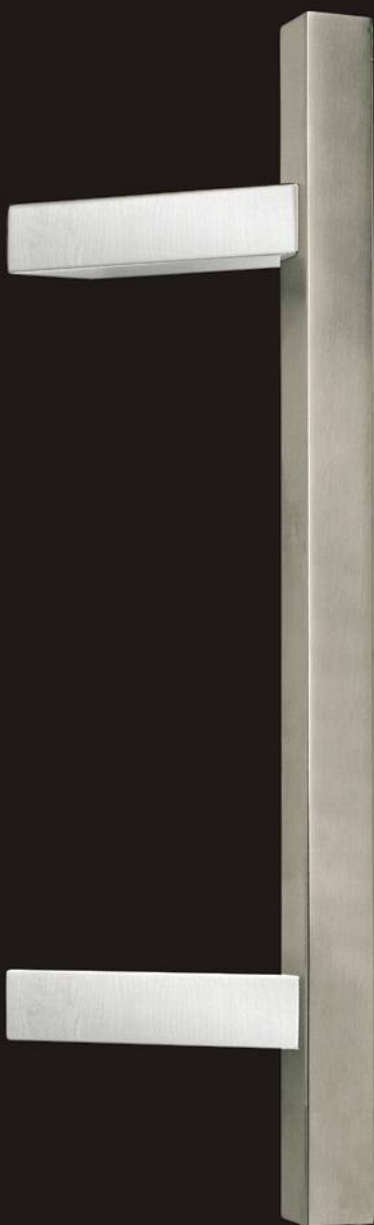

810/164



810/166

810/164

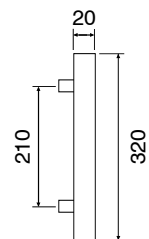

810/166

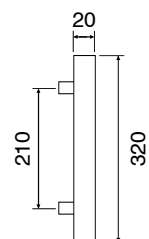

FINITURE - FINISHING

F11

Cromo lucido - Nickel satinato
Polish chrome - Satin nickel

F66

Cromo lucido - Cromo satinato
Polish chrome - Satin chrome



800/164



800/166

800/164

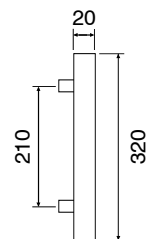

800/166

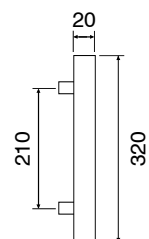

FINITURE - FINISHING

F11

Cromo lucido - Nikel satinato
Polish chrome - Satin nickel

F66

Cromo lucido - Cromo satinato
Polish chrome - Satin chrome



LINEAR

La nostre MANIGLIE LINEAR sono maniglie dalla linea semplice e sobria,
di livello economico ma costruite con materiale di prima scelta,
adattabili a diversi mercati.

*Our LINEAR RANGE is composed by handles with simple and sober lines,
of economic level but built with high-grade material,
adaptable to different markets.*

Bianchi Vittore



LINEAR



SABRINA 159

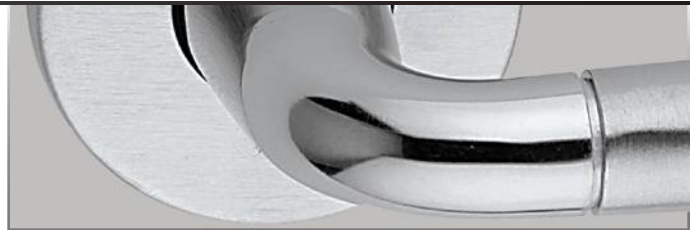



159/273

Maniglia con rosetta
Handle with rosette

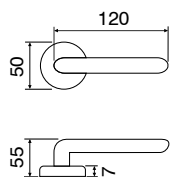

159/202L

Maniglia con placca
Handle with plate

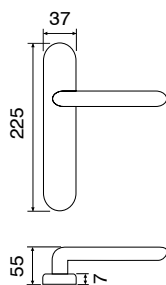

159 D.K.

Maniglia anta ribalta
Tilt and turn handle

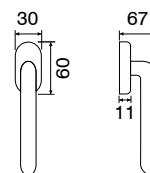

FINITURE - FINISHING



159/273 - F04

Cromo lucido
Polish chrome



159/273 - F05

Cromo satinato
Satin chrome



159/273 - F66

Cromo lucido / Cromo satinato
Polish chrome / Satin chrome



DANIELA 179





179/273

Maniglia con rosetta
Handle with rosette

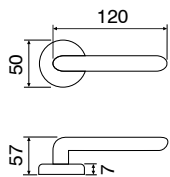

179/202L

Maniglia con placca
Handle with plate

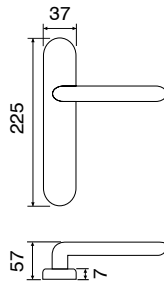

179 D.K.

Maniglia anta ribalta
Tilt and turn handle

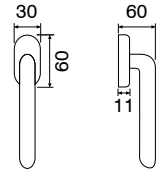

FINITURE - FINISHING



179/273 - F04

Cromo lucido
Polish chrome



179/273 - F05

Cromo satinato
Satin chrome



179/273 - F66

Cromo lucido / Cromo satinato
Polish chrome / Satin chrome

 SILVIA 149

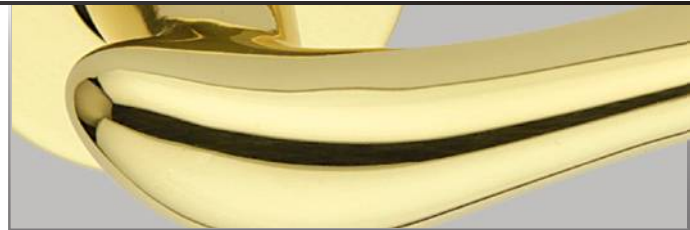
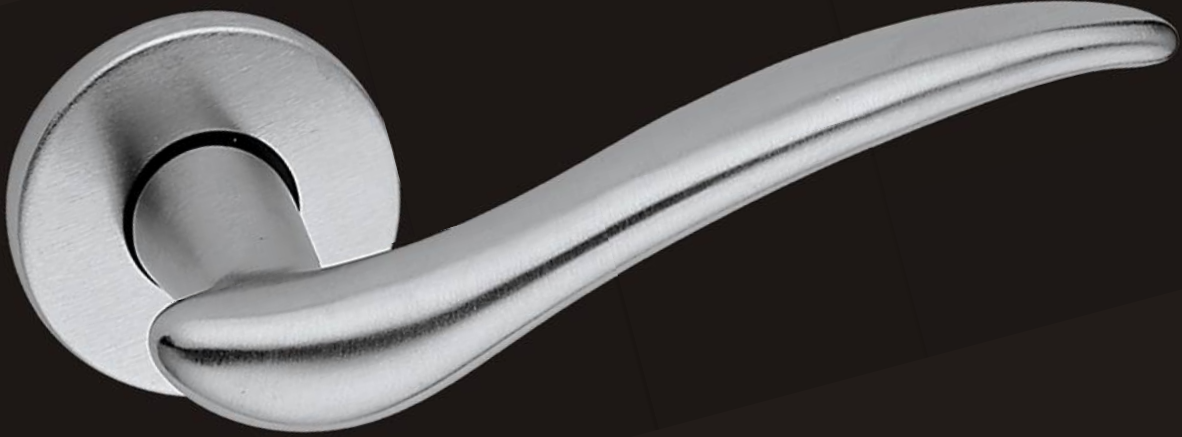



149/273

Maniglia con rosetta
Handle with rosette

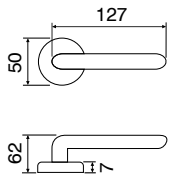

149/202L

Maniglia con placca
Handle with plate

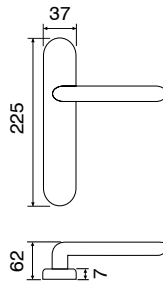

149 D.K.

Maniglia anta ribalta
Tilt and turn handle

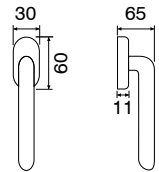

FINITURE - FINISHING



149/273 - F04

Cromo lucido
Polish chrome



149/273 - F01

Ottone lucido
Polish brass



149/273 - F05

Cromo satinato
Satin chrome



DIAMOND 199





199/273

Maniglia con rosetta
Handle with rosette

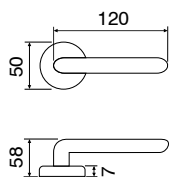

199/202L

Maniglia con placca
Handle with plate

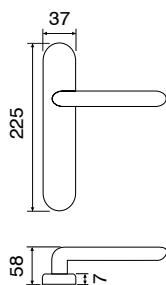

199 D.K.

Maniglia anta ribalta
Tilt and turn handle

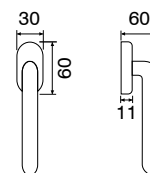

FINITURE - FINISHING



199/273 - F04

Cromo lucido
Polish chrome



199/273 - F05

Cromo satinato
Satin chrome



199/211B - F05

Cromo satinato
Satin chrome



GIORGIA 169





169/273

Maniglia con rosetta
Handle with rosette

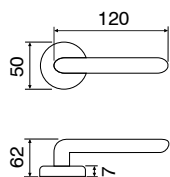

169/202L

Maniglia con placca
Handle with plate

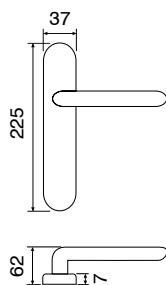

169 D.K.

Maniglia anta ribalta
Tilt and turn handle

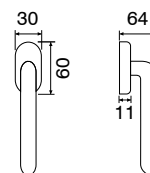

FINITURE - FINISHING



169/273 - F04

Cromo lucido
Polish chrome



169/273 - F05

Cromo satinato
Satin chrome



169/273 - F66

Cromo lucido / Cromo satinato
Polish chrome / Satin chrome



169/211B - F05

Cromo satinato
Satin chrome



HORNET 145





145/273

Maniglia con rosetta
Handle with rosette

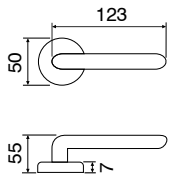

145/205

Maniglia con placca
Handle with plate

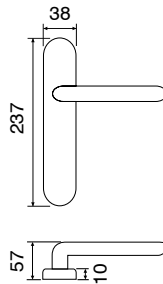

145 D.K.

Maniglia anta ribalta
Tilt and turn handle

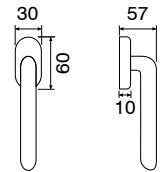

FINITURE - FINISHING



145/273 - F02

Ottone satinato
Satin brass



145/273 - F20

Nikel satinato
Satin nickel



145/273 - F05

Cromo satinato
Satin chrome

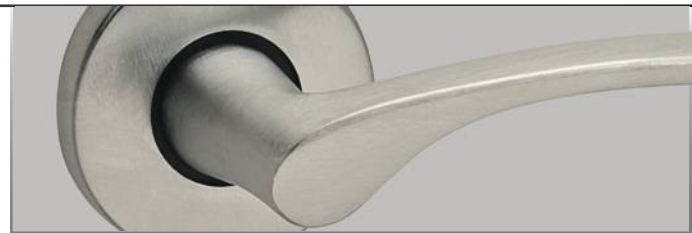



122/273

Maniglia con rosetta
Handle with rosette

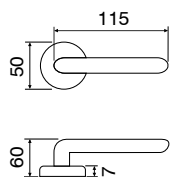

122/205

Maniglia con placca
Handle with plate

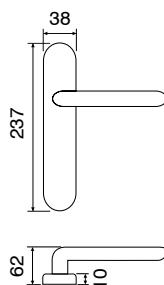

122 D.K.

Maniglia anta ribalta
Tilt and turn handle

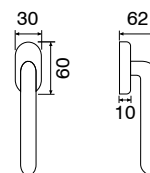

FINITURE - FINISHING



122/273 - F05

Cromo satinato
Satin chrome



122/273 - F20

Nikel satinato
Satin nickel

GRACE 127

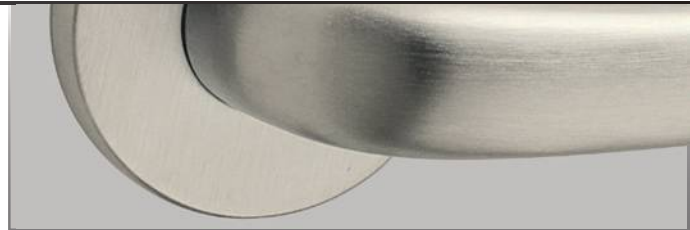



127/273

Maniglia con rosetta
Handle with rosette

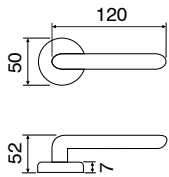

127/202L

Maniglia con placca
Handle with plate

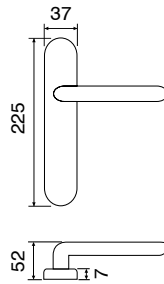

127 D.K.

Maniglia anta ribalta
Tilt and turn handle

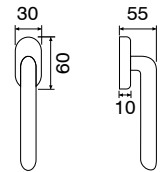

FINITURE - FINISHING



127/273 - F05

Cromo satinato
Satin chrome



127/273 - F20

Nikel satinato
Satin nickel



ANNE MARIE 197





197/231B

Maniglia con rosetta
Handle with rosette

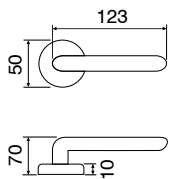

197/270

Maniglia con placca
Handle with plate

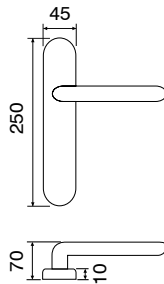

197 D.K.

Maniglia anta ribalta
Tilt and turn handle

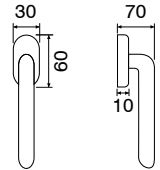

FINITURE - FINISHING



197/231B - F01

Ottone lucido
Polish brass



197/231B - F05

Cromo satinato
Satin chrome



197/231B - F04

Cromo lucido
Polish chrome



RAINBOW 123

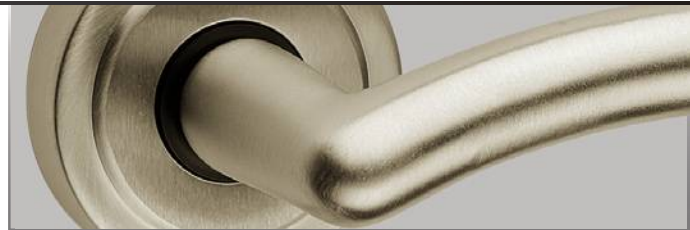



123/230R

Maniglia con rosetta
Handle with rosette

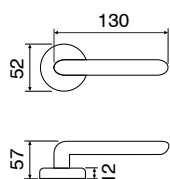

123/270

Maniglia con placca
Handle with plate

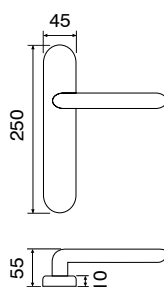

123 D.K.

Maniglia anta ribalta
Tilt and turn handle

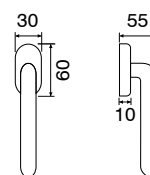

FINITURE - FINISHING



123/230R - F01

Ottone lucido
Polish brass



123/230R - F05

Cromo satinato
Satin chrome



123/230R - F20

Nikel satinato
Satin nickel



OLIMPIC 100

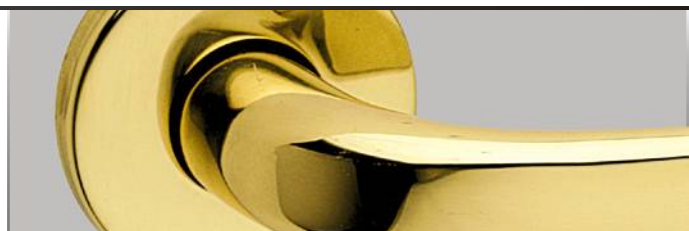



100/273

Maniglia con rosetta
Handle with rosette

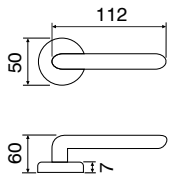

100/205

Maniglia con placca
Handle with plate

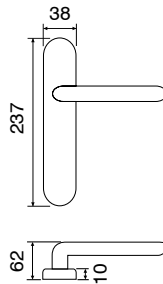

100 D.K.

Maniglia anta ribalta
Tilt and turn handle

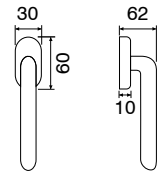

FINITURE - FINISHING



100/273 - F01

Ottone lucido
Polish brass



100/273 - F05

Cromo satinato
Satin chrome





126/273

Maniglia con rosetta
Handle with rosette

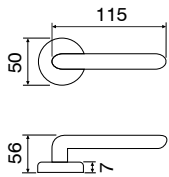

126/202L

Maniglia con placca
Handle with plate

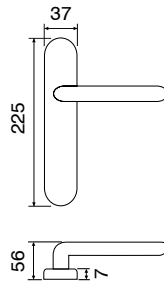

121 D.K.

Maniglia anta ribalta
Tilt and turn handle

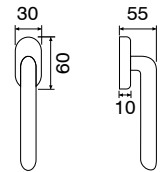

FINITURE - FINISHING



126/273 - F01

Ottone lucido
Polish brass



126/273 - F04

Cromo lucido
Polish chrome



126/273 - F23

Bronzo antico
Aged bronzed brass



126/273 - F02

Ottone satinato
Satin brass



126/273 - F05

Cromo satinato
Satin chrome



126/273 - F20

Nikel satinato
Satin nickel

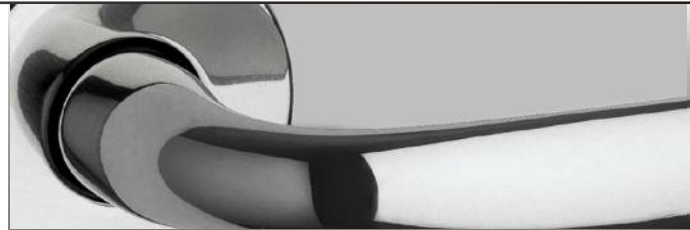



121/273

Maniglia con rosetta
Handle with rosette

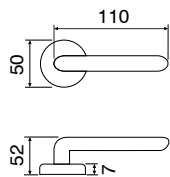

121/202L

Maniglia con placca
Handle with plate

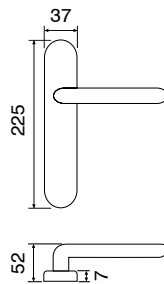

121 D.K.

Maniglia anta ribalta
Tilt and turn handle

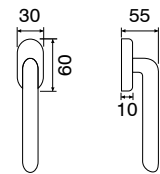

FINITURE - FINISHING



121/273 - F01

Ottone lucido
Polish brass



121/273 - F02

Ottone satinato
Satin brass



121/273 - F04

Cromo lucido
Polish chrome



121/273 - F05

Cromo satinato
Satin chrome



121/273 - F20

Nikel satinato
Satin nickel



FLY 130





130/273

Maniglia con rosetta
Handle with rosette

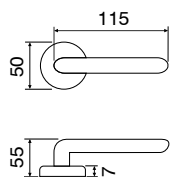

130/202L

Maniglia con placca
Handle with plate

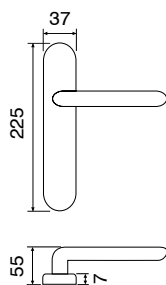

130 D.K.

Maniglia anta ribalta
Tilt and turn handle

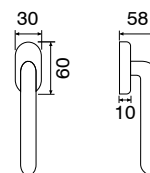

FINITURE - FINISHING



130/273 - F01

Ottone lucido
Polish brass



130/273 - F05

Cromo satinato
Satin chrome



130/273 - F04

Cromo lucido
Polish chrome



SHADOW 120





120/230

Maniglia con rosetta
Handle with rosette

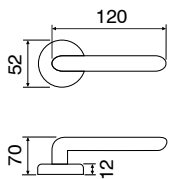

120/202P

Maniglia con placca
Handle with plate

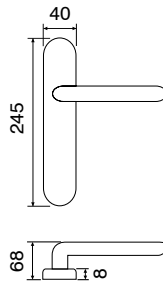

120 D.K.

Maniglia anta ribalta
Tilt and turn handle

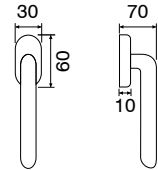

FINITURE - FINISHING



120/230 - F01

Ottone lucido
Polish brass



120/230 - F03

Ottone bronzato
Bronzed brass



120/230 - F04

Cromo lucido
Polish chrome

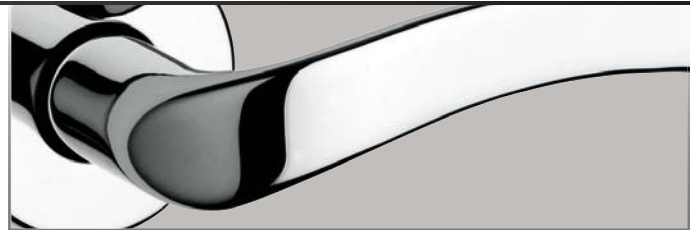



124/273

Maniglia con rosetta
Handle with rosette

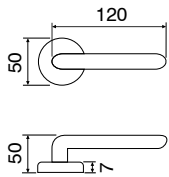

124/202L

Maniglia con placca
Handle with plate

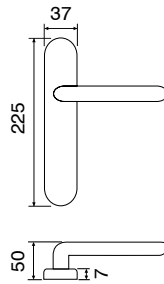

124 D.K.

Maniglia anta ribalta
Tilt and turn handle

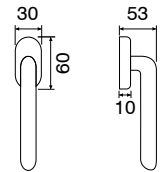

FINITURE - FINISHING

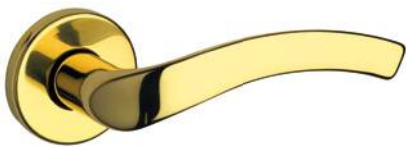

124/273 - F01

Ottone lucido
Polish brass



124/273 - F02

Ottone satinato
Satin brass



124/273 - F04

Cromo lucido
Polish chrome



124/273 - F05

Cromo satinato
Satin chrome





113/231B

Maniglia con rosetta
Handle with rosette

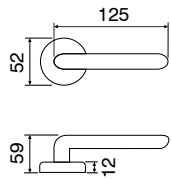

113/202

Maniglia con placca
Handle with plate

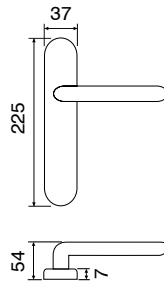

113 D.K.

Maniglia anta ribalta
Tilt and turn handle

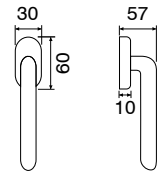

FINITURE - FINISHING



113/231B - F01

Ottone lucido
Polish brass



113/231B - F04

Cromo lucido
Polish chrome

FIONA 128





128/273

Maniglia con rosetta
Handle with rosette

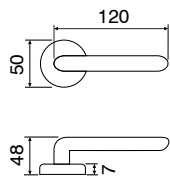

128/202L

Maniglia con placca
Handle with plate

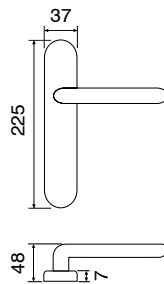

128 D.K.

Maniglia anta ribalta
Tilt and turn handle

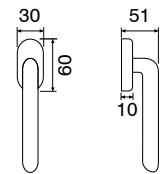

FINITURE - FINISHING

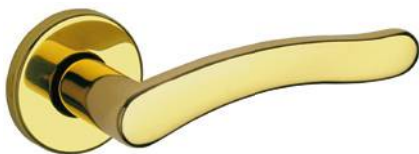

128/273 - F01

Ottone lucido
Polish brass



128/273 - F04

Cromo lucido
Polish chrome



SOUBRETTE 115

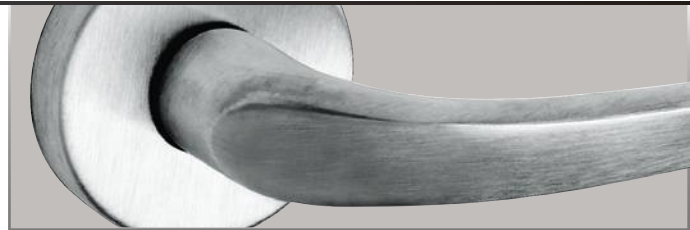



115/230

Maniglia con rosetta
Handle with rosette

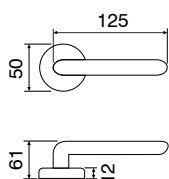

115/202

Maniglia con placca
Handle with plate

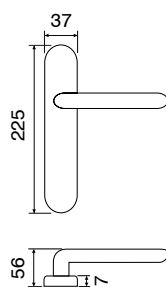

115 D.K.

Maniglia anta ribalta
Tilt and turn handle

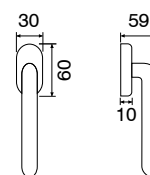

FINITURE - FINISHING



115/230 - F01

Ottone lucido
Polish brass



115/230 - F02

Ottone satinato
Satin brass



115/230 - F05

Cromo satinato
Satin chrome



DUCK 153





153/273

Maniglia con rosetta
Handle with rosette

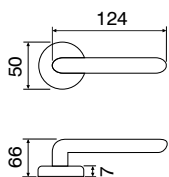

153/234

Maniglia con placca
Handle with plate

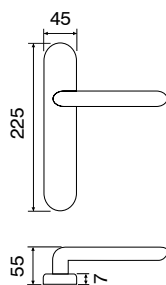

153/228

Maniglia con placca
Handle with plate

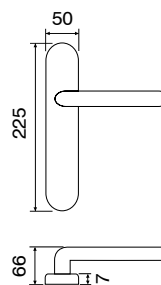

FINITURE - FINISHING



153/273 - F01

Ottone lucido
Polish brass



153/273 - F03

Ottone bronzato
Bronzed brass

 **QUADRA**



163 ALU/211BIC - F11

Maniglia con rosetta
Handle with rosette

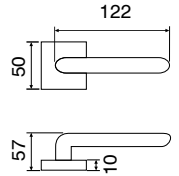

 **WAVE**



190 ALU/231B - F20

Maniglia con rosetta
Handle with rosette

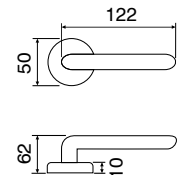

 **SNAKE**



188P ALU/231B - F20

Maniglia con rosetta
Handle with rosette

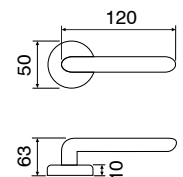

 **STICK**



116/231B - F11

Maniglia con rosetta
Handle with rosette

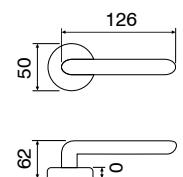

F11

Cromo lucido - Nikel satinato
Chrome - Satin nikel

F20

Nikel satinato
Satin nikel

FINITURE - FINISHING



ACCESSORI



MANIGLIONI

PULL-HANDLE

ART. 148 STG/231C



148 STG/231C

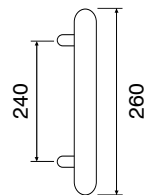

ART. 147P STG/250



147P STG/250

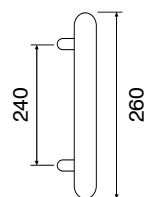

ART. 105 STG/265



105 STG/265

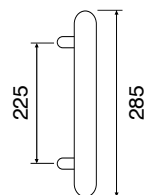

ART. 106 STG/269



106 STG/269



106 STG/269

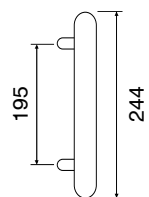

ART. 111STG/211B



111 STG/211B

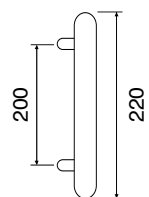

FINITURE - FINISHING

Disponibile in diverse finiture

Available in different finishing



PULL-HANDLE



147 STG/250



152 STG/231C



154 STG/266

ART. 147 STG/250

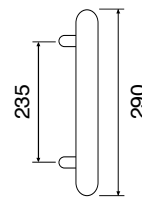

ART. 152 STG/231C

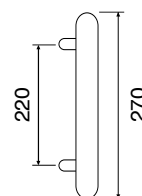

ART. 154 STG/266

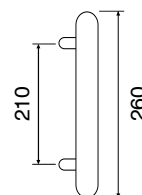

ART. 3294

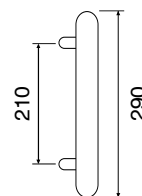

ART. 3293

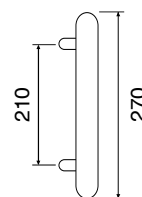

ART. 3291

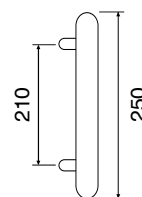

3294



3293



3291

FINITURE - FINISHING

Disponibile in diverse finiture

Available in different finishing



MANIGLIONI

PULL-HANDLE



125 STG/231



139 STG/231C



184 STG/231

ART. 125 STG/231

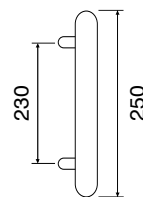

ART. 139 STG/231C

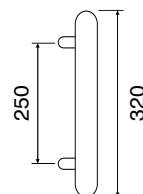

ART. 184 STG/231

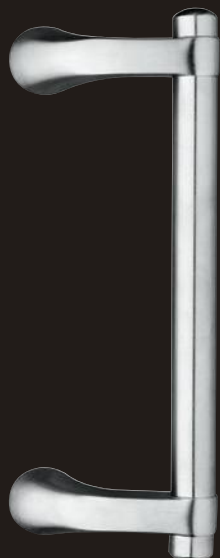
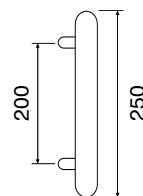

9060

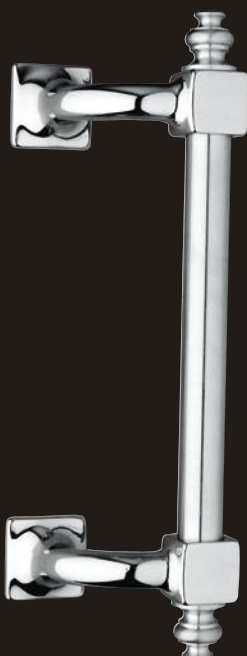

3292



3290

ART. 9060

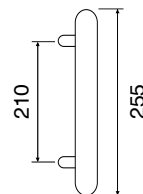

ART. 3292

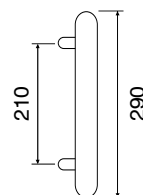

ART. 3290

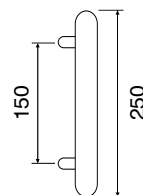

FINITURE - FINISHING

Disponibile in diverse finiture

Available in different finishing



MANIGLIONI

PULL-HANDLE

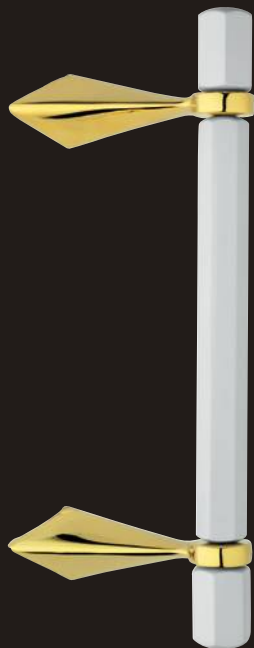

3272

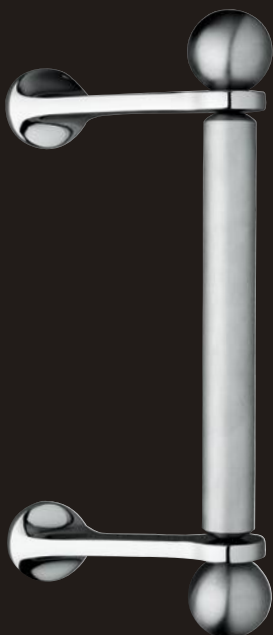

3270



3281



3280C

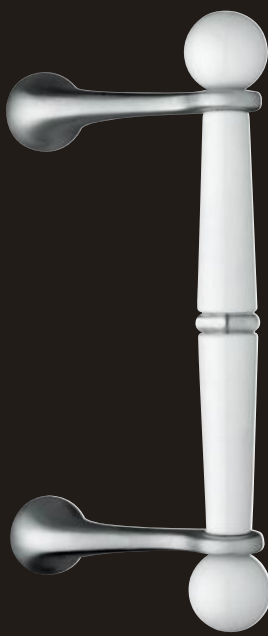

3280

ART. 3272

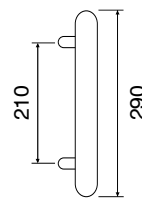

ART. 3270

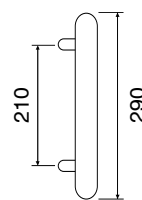

ART. 3281

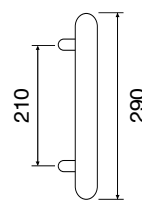

ART. 3280C

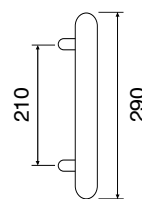

ART. 3280

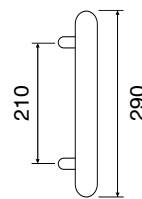

FINITURE - FINISHING

Disponibile in diverse finiture

Available in different finishing



BATTENTI

KNOCKERS



3730



3715V

ART. 3730

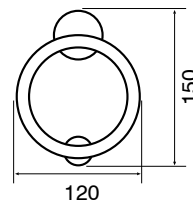

ART. 3715V

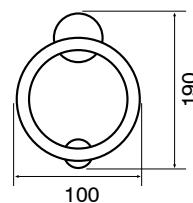

3725



3710

ART. 3725

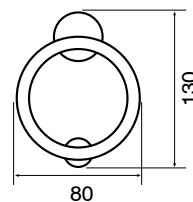

ART. 3710

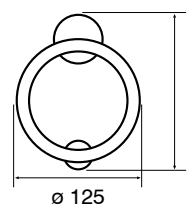

3720



3705

ART. 3720

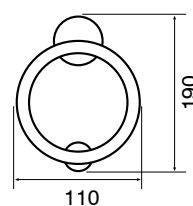

ART. 3705

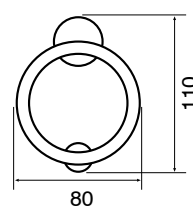

FINITURE - FINISHING

Disponibile in diverse finiture

Available in different finishing



BUCA DA LETTERE

LETTER BOX



5005

ART. 5005

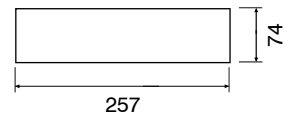

5003S

ART. 5003S

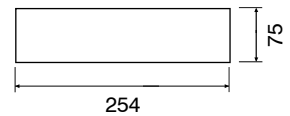

5003

ART. 5003

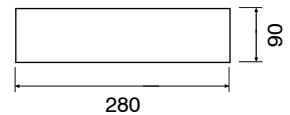

5002

ART. 5002

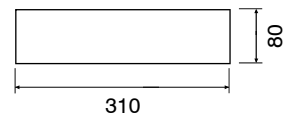

5012

ART. 5012

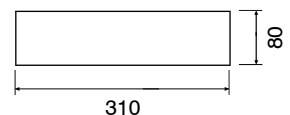

F01

Ottone lucido
Polished brass

F03

Ottone bronzato
Bronzed brass

F04

Cromo lucido
Chrome

F05

Cromo satinato
Satin chrome

FINITURE - FINISHING



POMOLI

KNOBS



305



323



325



341



326



350



328



308



386



370

ART. 305

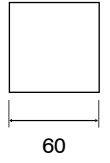

60

ART. 323

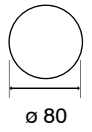

ø 80

ART. 325

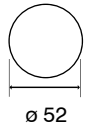

ø 52

ART. 341

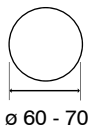

ø 60 - 70

ART. 326

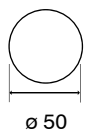

ø 50

ART. 350

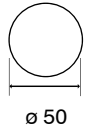

ø 50

ART. 328

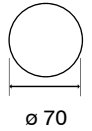

ø 70

ART. 308

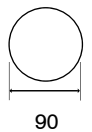

90

ART. 386

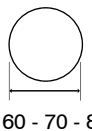

ø 60 - 70 - 80

ART. 370

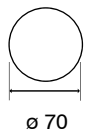

ø 70

FINITURE - FINISHING

Disponibile in diverse finiture

Available in different finishing

FERMAPORTA

DOOR STOPPER



3690



3695



3698

ART. 3690



ART. 3695

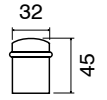

ART. 3698

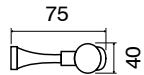

TARGHETTE

PLATES



3105



3106



4030



4037

ART. 4030

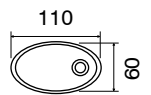

ART. 4037

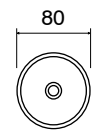

COPRICERNIERE

OVER-HINGES



3151

ø 14 mm
ø 15 mm
ø 16 mm



3154

ø 14 mm
ø 15 mm
ø 16 mm



3158

ø 14 mm
ø 15 mm
ø 16 mm

ART. 3151

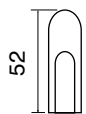

ART. 3154

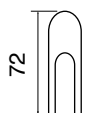

ART. 3158

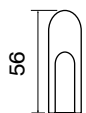

FINITURE - FINISHING

Disponibile in diverse finiture

Available in different finishing



3665F



MT



LOCH 60-50 KEY

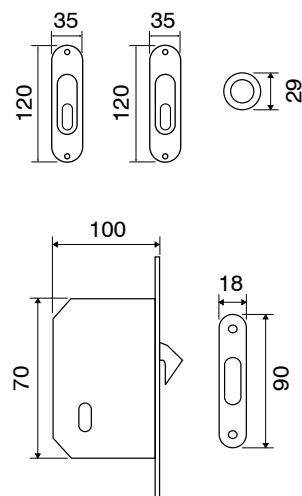

3665R



MT



LOCH 61-50 WC

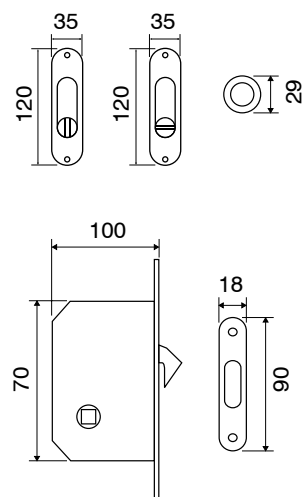

3665C



MT

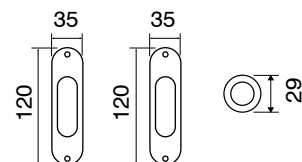

FINITURE - FINISHING

Disponibile in diverse finiture

Available in different finishing



KIT

PER PORTE SCORREVOLI

KIT FOR SLIDING DOORS

3666F



3667F



3666R



3667R



3666C



3667C



MT



MQ



LOCH 60-50 KEY



LOCH 61-50 WC

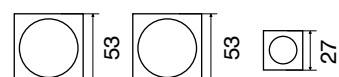
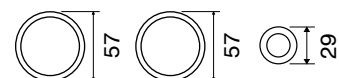
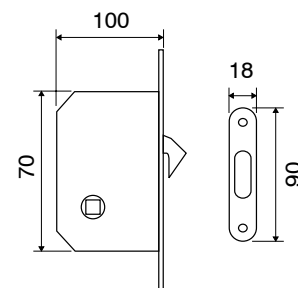
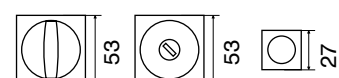
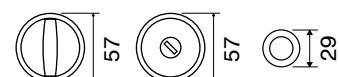
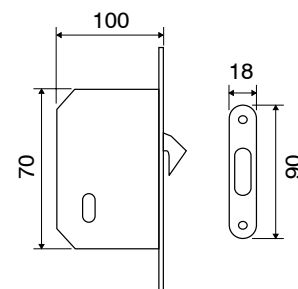
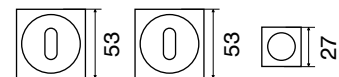

FINITURE - FINISHING

Disponibile in diverse finiture

Available in different finishing



3665AF



MT



LOCH 60-50 KEY

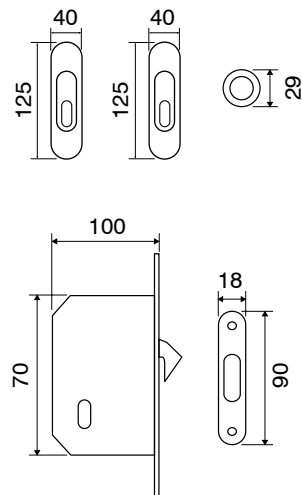

3665AR



MT



LOCH 61-50 WC

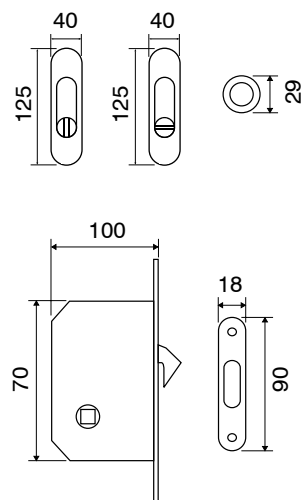

3665AC



MT

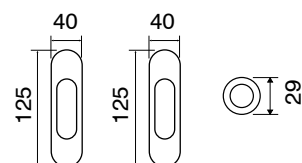

FINITURE - FINISHING

Disponibile in diverse finiture

Available in different finishing



KIT

PER PORTE SCORREVOLI

KIT FOR SLIDING DOORS

3663AF



MQ



LOCH 60-50 KEY

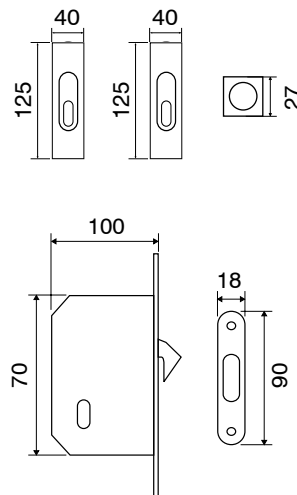

3663AR



MQ



LOCH 61-50 WC

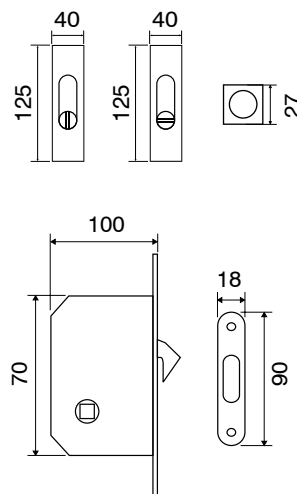

3663AC



MQ

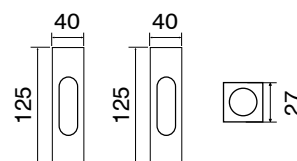

Disponibile in diverse finiture

Available in different finishing

FINITURE - FINISHING



SERRATURE

LOCK



by **Bonaiti**
SERRATURE



NOTTOLINI

URNS & RELEASES

315

∅ 4 - 6 - 7 - 8 mm



310

∅ 4 - 6 - 7 - 8 mm



FINITURE - FINISHING

Disponibile in diverse finiture

Available in different finishing

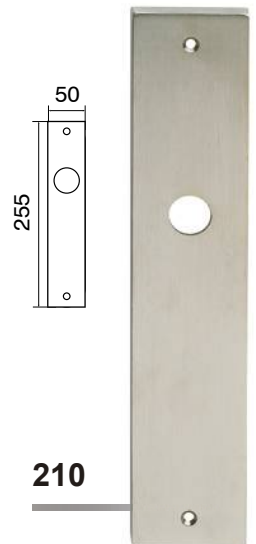
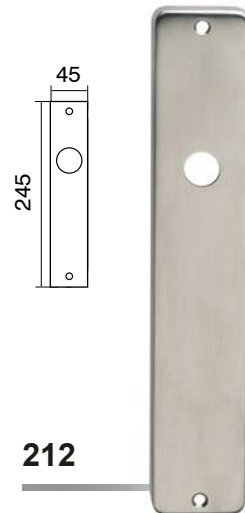
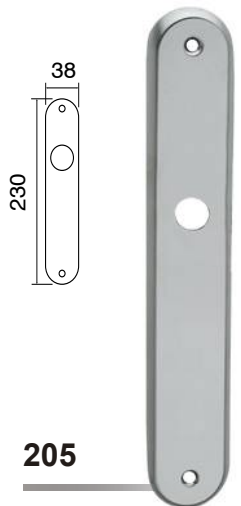
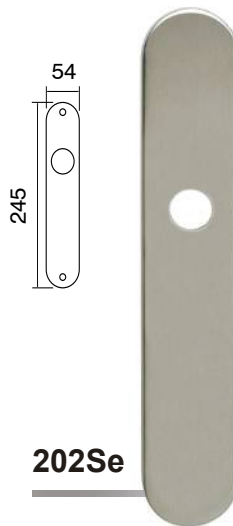
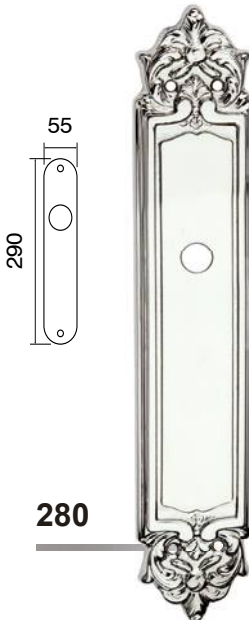
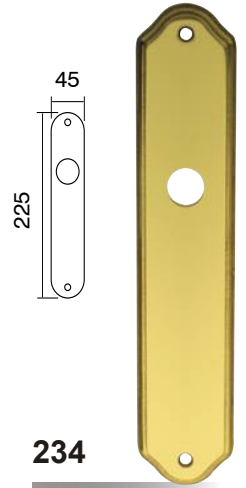
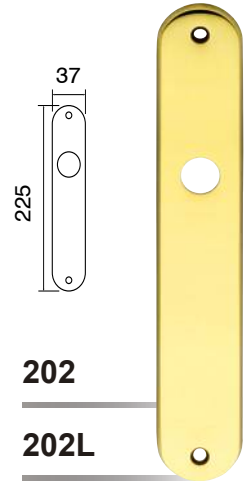
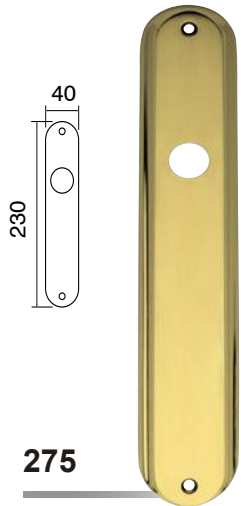
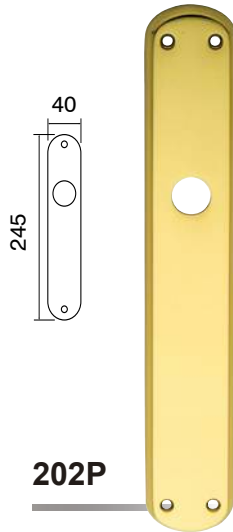
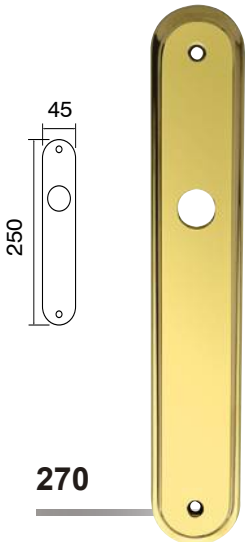
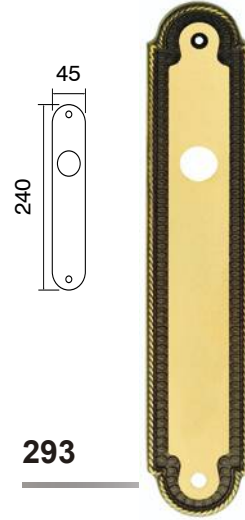
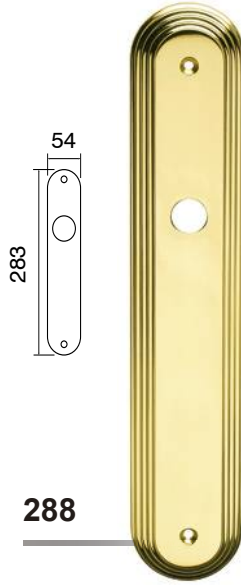
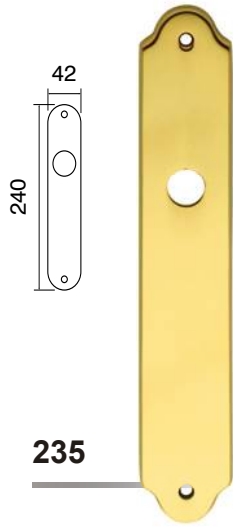



SOTTOROSETTE

UNDER ROSE



240

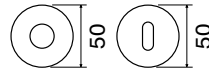

269

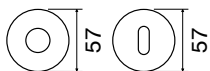

265

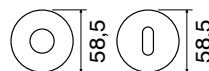

211 BIC

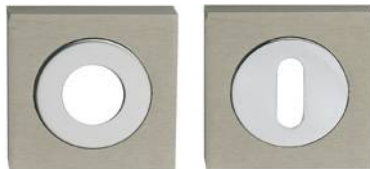
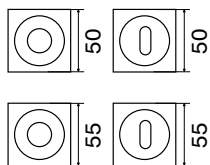

250

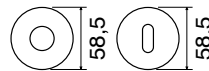

266



231 C

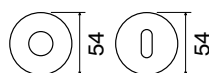

231 B with round or sharp edge

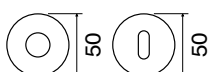

294

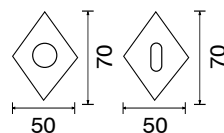



215

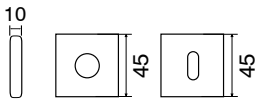

211 B

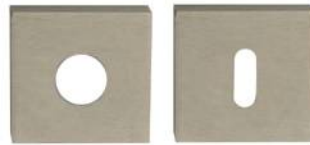
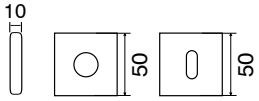

SOTTOROSETTE QUADRE IN PLASTICA

SQUARE UNDER ROSE IN PLASTIC



236



230 R

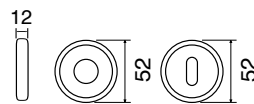

SOTTOROSETTE TONDE IN ZAMA

ROUND UNDER ROSE IN METAL



273



230



SOTTOROSETTE TONDE IN PLASTICA

ROUND UNDER ROSE IN PLASTIC



231

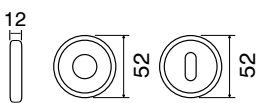

277

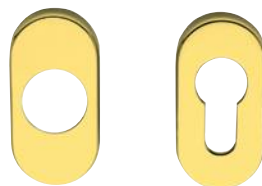
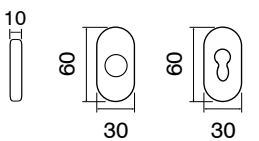

SOTTOROSETTE OVALI IN PLASTICA

OVAL UNDER ROSE IN PLASTIC

276

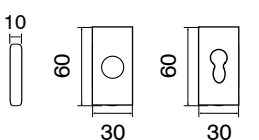



ACCIAIO

La nostra gamma in ACCIAIO INOX, aggiunta una decina di anni fa
per rispondere al meglio alle esigenze dei nostri clienti.
Maniglie economiche ma durature per grandi progetti.

*Our STAINLESS STEEL range, added a dozen years ago
to better respond to the needs of our customers.
Cheap handles but long-lasting for big projects.*

Bianchi Vittore

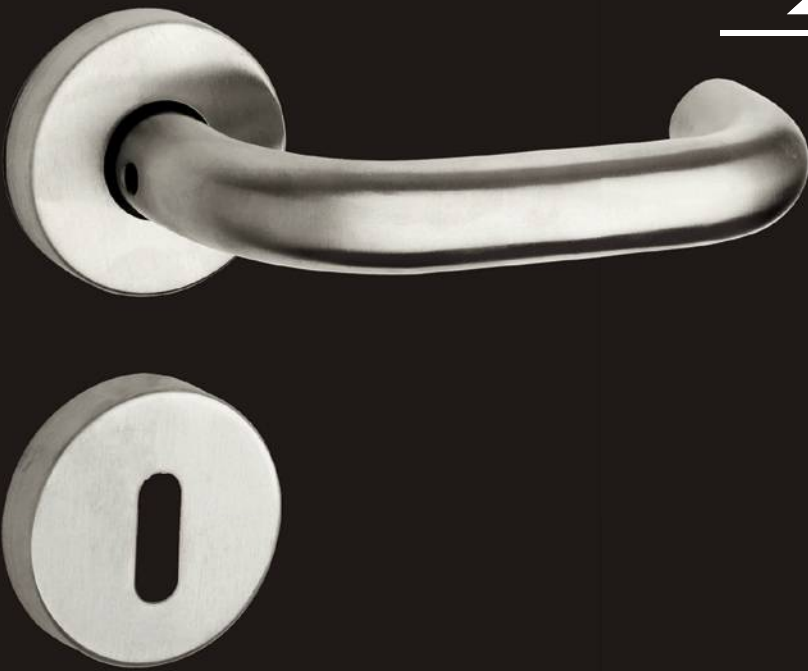

101/236

Maniglia con rosetta
Handle with rosette

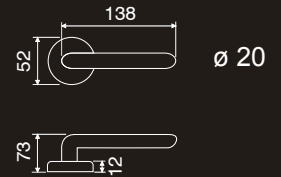

101/277

Maniglia con rosetta ovale
Handle with oval rosette

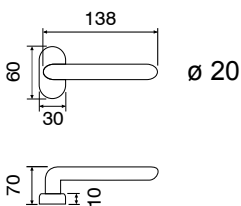

101/202L

Maniglia con placca
Handle with plate

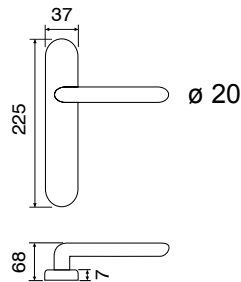

101 D.K.

Maniglia anta ribalta
Tilt and turn handle

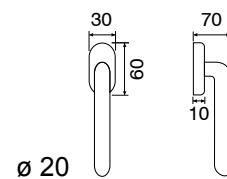

F60

Inox satinato
Satin steel

FINITURE - FINISHING

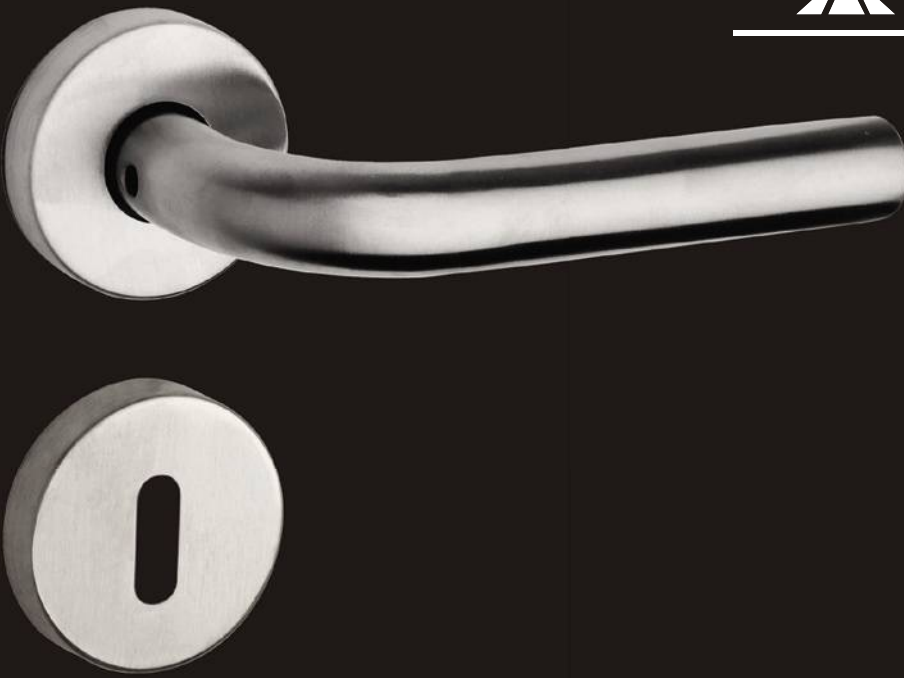

103/236

Maniglia con rosetta
Handle with rosette

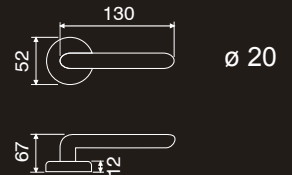

103/277

Maniglia con rosetta ovale
Handle with oval rosette

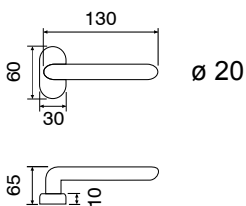

103/202L

Maniglia con placca
Handle with plate

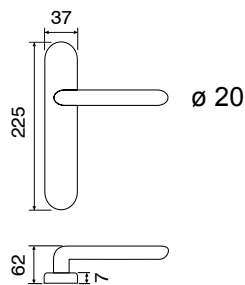

103 D.K.

Maniglia anta ribalta
Tilt and turn handle

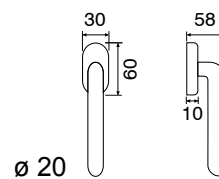

F60

Inox satinato
Satin steel

FINITURE - FINISHING



102/236

Maniglia con rosetta
Handle with rosette

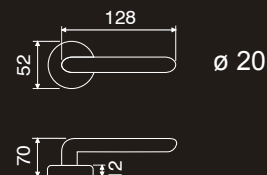

102/277

Maniglia con rosetta ovale
Handle with oval rosette

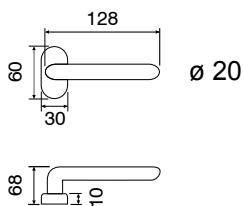

102/202L

Maniglia con placca
Handle with plate

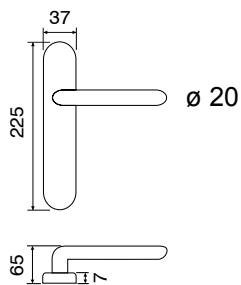

102 D.K.

Maniglia anta ribalta
Tilt and turn handle

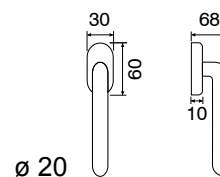

F60

Inox satinato
Satin steel

FINITURE - FINISHING

SQUARE



102/211B

Maniglia con rosetta
Handle with rosette

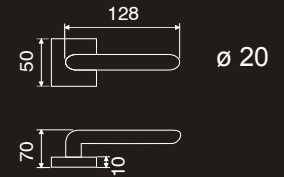

102/212

Maniglia con placca
Handle with plate

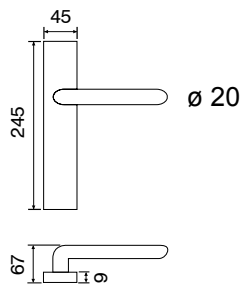

102 D.K.R.

Maniglia anta ribalta
Tilt and turn handle

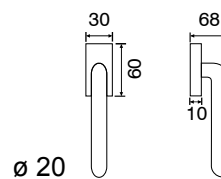

F60

Inox satinato
Satin steel

FINITURE - FINISHING



104/236

Maniglia con rosetta
Handle with rosette

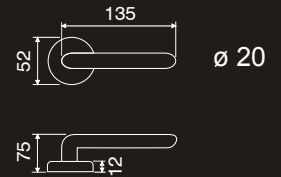

104/277

Maniglia con rosetta ovale
Handle with oval rosette

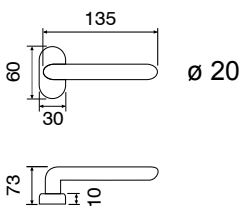

104/202L

Maniglia con placca
Handle with plate

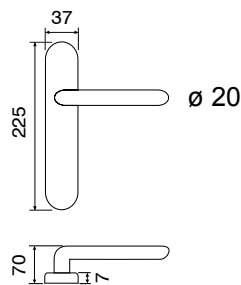

104 D.K.

Maniglia anta ribalta
Tilt and turn handle

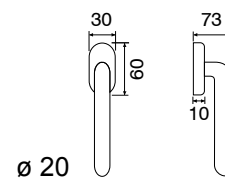

F60

Inox satinato
Satin steel

FINITURE - FINISHING

SQUARE

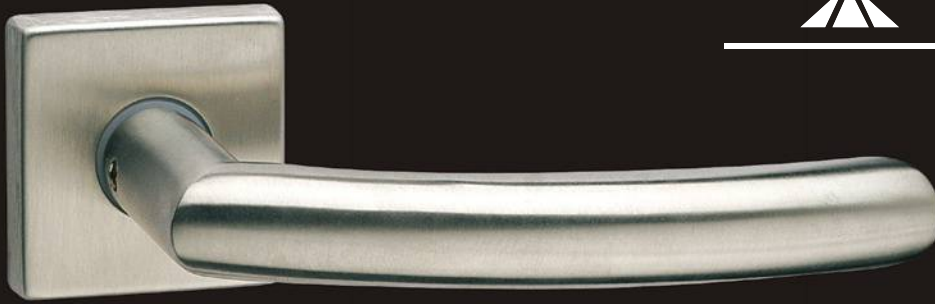

104/211B

Maniglia con rosetta
Handle with rosette

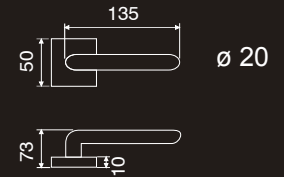

104/212

Maniglia con placca
Handle with plate

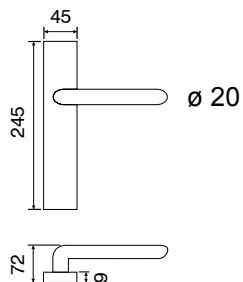

104 D.K.R.

Maniglia anta ribalta
Tilt and turn handle

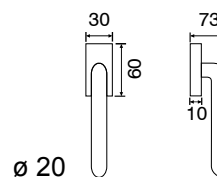

F60

Inox satinato
Satin steel

FINITURE - FINISHING



131/236

Maniglia con rosetta
Handle with rosette

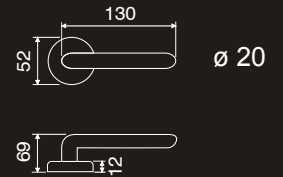

131/277

Maniglia con rosetta ovale
Handle with oval rosette

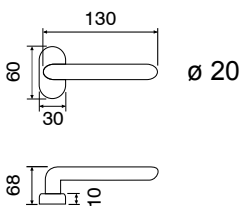

131/202L

Maniglia con placca
Handle with plate

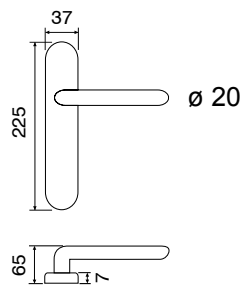

104 D.K.

Maniglia anta ribalta
Tilt and turn handle

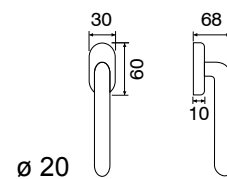

F60

Inox satinato
Satin steel

FINITURE - FINISHING

SQUARE



131/211B

Maniglia con rosetta
Handle with rosette

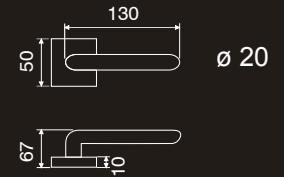

131/212

Maniglia con placca
Handle with plate

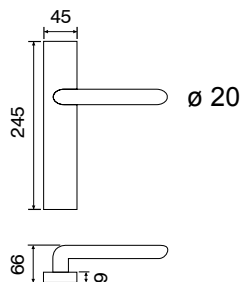

104 D.K.R.

Maniglia anta ribalta
Tilt and turn handle

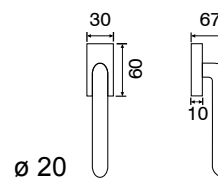

F60

Inox satinato
Satin steel

FINITURE - FINISHING



135/236

Maniglia con rosetta
Handle with rosette

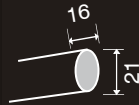
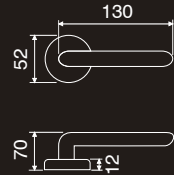

Impugnatura ovale 21x16 mm
Oval hilt 21x16 mm



135/277

Maniglia con rosetta ovale
Handle with oval rosette

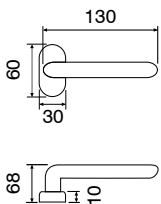

135/202L

Maniglia con placca
Handle with plate

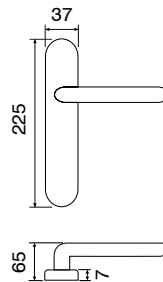

102 D.K.

Maniglia anta ribalta
Tilt and turn handle

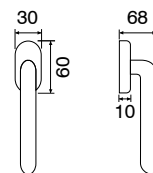

F60

Inox satinato
Satin steel

FINITURE - FINISHING



INOX 135

SQUARE



135/211B

Maniglia con rosetta
Handle with rosette

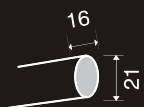

Impugnatura ovale 21x16 mm

Oval hilt 21x16 mm

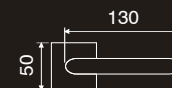

135/212

Maniglia con placca
Handle with plate

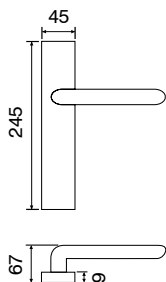

102 D.K.R.

Maniglia anta ribalta
Tilt and turn handle

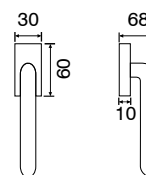

F60

Inox satinato
Satin steel

FINITURE - FINISHING



133/231

Maniglia con rosetta
Handle with rosette

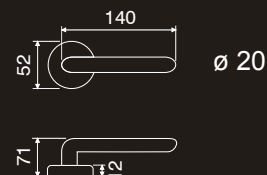

133/277

Maniglia con rosetta ovale
Handle with oval rosette

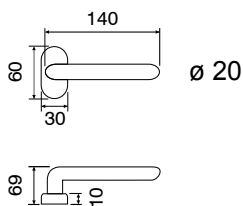

133/202L

Maniglia con placca
Handle with plate

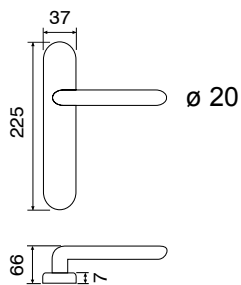

102 D.K.

Maniglia anta ribalta
Tilt and turn handle

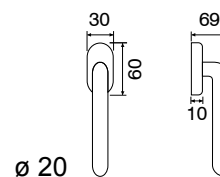

F60

Inox satinato
Satin steel

FINITURE - FINISHING

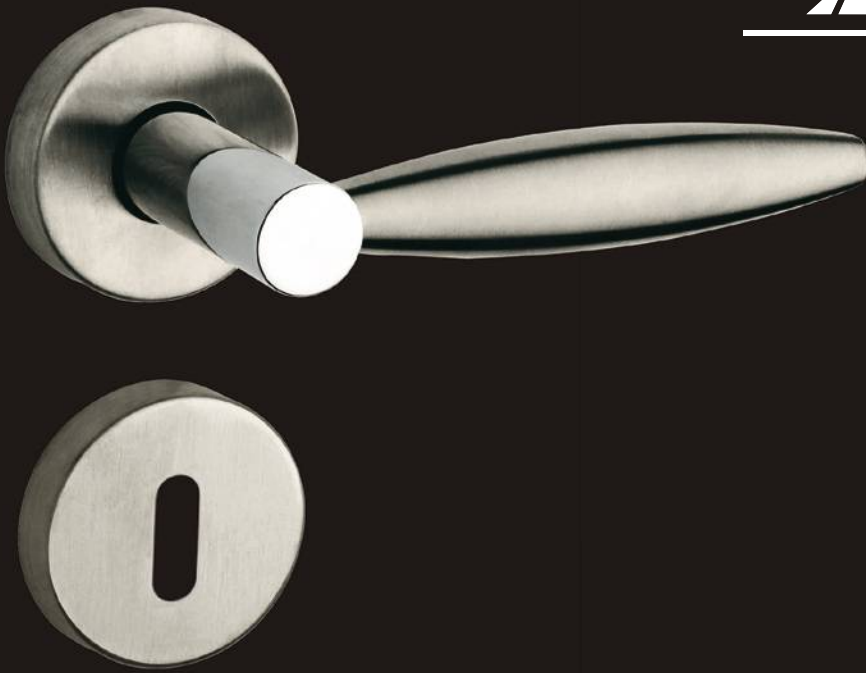

180/236

Maniglia con rosetta
Handle with rosette

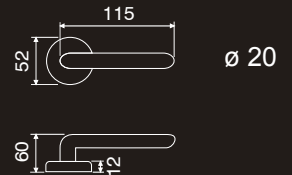

180/277

Maniglia con rosetta ovale
Handle with oval rosette

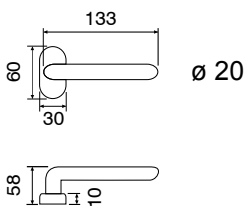

180/202L

Maniglia con placca
Handle with plate

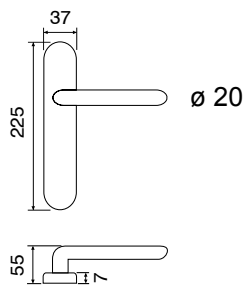

180 D.K.

Maniglia anta ribalta
Tilt and turn handle

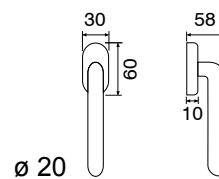

F60

Inox satinato
Satin steel

FINITURE - FINISHING



INOX 189 BIC



189 BIC/236

Maniglia con rosetta
Handle with rosette

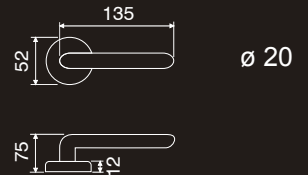

189 BIC/277

Maniglia con rosetta ovale
Handle with oval rosette

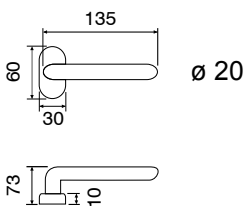

189 BIC/202L

Maniglia con placca
Handle with plate

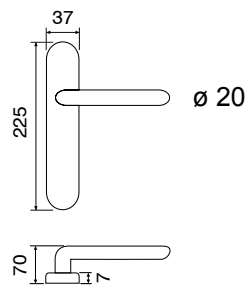

189 BIC D.K.

Maniglia anta ribalta
Tilt and turn handle

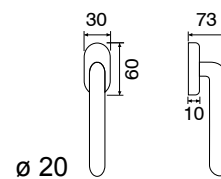

F60

Inox satinato
Satin steel

FINITURE - FINISHING



CLUB.ER 110ER



110ER/231

Maniglia con rosetta
Handle with rosette

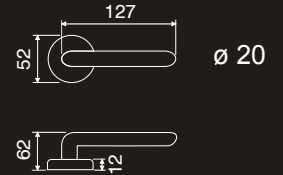

110ER/277

Maniglia con rosetta ovale
Handle with oval rosette

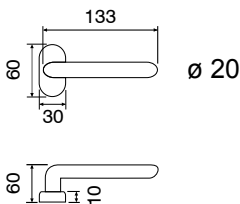

110ER/202L

Maniglia con placca
Handle with plate

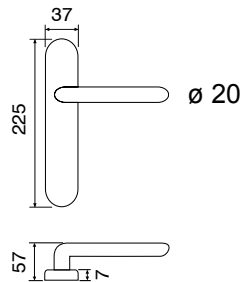

110ER D.K.

Maniglia anta ribalta
Tilt and turn handle

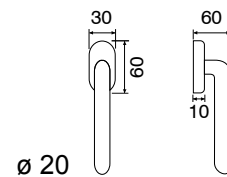

F60

Inox satinato
Satin steel

FINITURE - FINISHING



CORNER.ER 114ER



114ER/231

Maniglia con rosetta
Handle with rosette

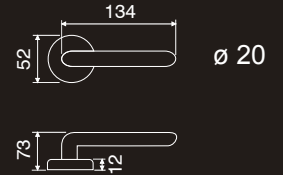

114ER/277

Maniglia con rosetta ovale
Handle with oval rosette

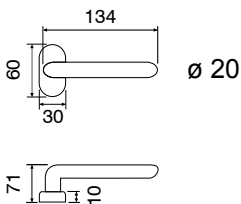

114ER/202L

Maniglia con placca
Handle with plate

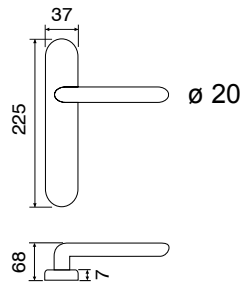

114ER D.K.

Maniglia anta ribalta
Tilt and turn handle

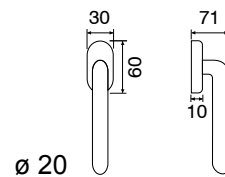

F60

Inox satinato
Satin steel

FINITURE - FINISHING

CORNER.ER 114ER

SQUARE

114ER/211B

Maniglia con rosetta
Handle with rosette

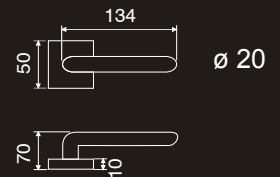

114ER/212

Maniglia con placca
Handle with plate

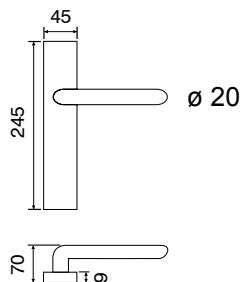

114ER D.K.R.

Maniglia anta ribalta
Tilt and turn handle

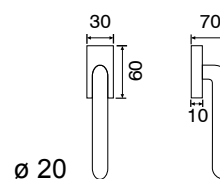

F60

Inox satinato
Satin steel

FINITURE - FINISHING



CUBIC 102K

SQUARE



102K/211B

Maniglia con rosetta
Handle with rosette

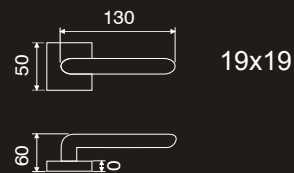

102K/212

Maniglia con placca
Handle with plate

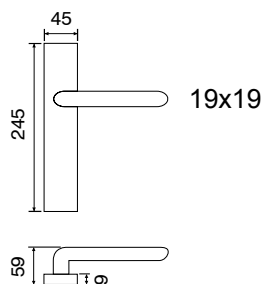

102K D.K.R.

Maniglia anta ribalta
Tilt and turn handle

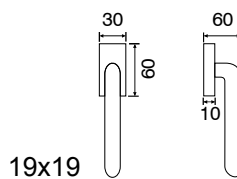

FINITURE - FINISHING

F60

Inox satinato
Satin steel



ACCESSORI

INOX



802K

ART. 802K

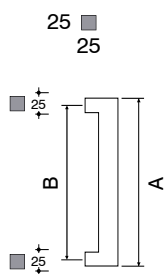

A	B
225	200
325	300
625	600
925	900
1225	1200



831

ART. 831

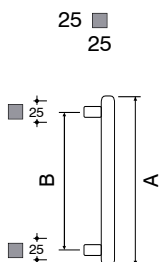

A	B
400	210
600	400
800	600



831Z

ART. 831Z

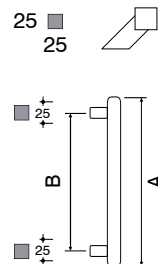

A	B
400	210
600	400
800	600



841C

ART. 841C

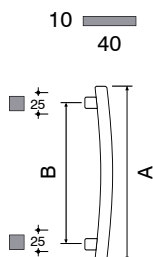

A	B
500	300
600	400
800	600



841S

ART. 841S

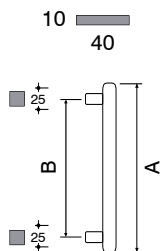

A	B
400	210
500	300
600	400
800	600



841Z

ART. 841Z

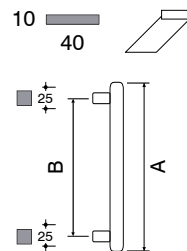

A	B
400	210
500	300
600	400
800	600





800

810

ART. 800

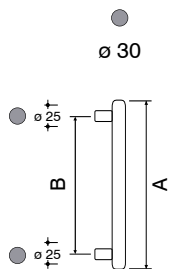

A	B
300	210
350	210
400	300
500	300
600	400
800	600
1000	700
1200	900
1500	1300
* 1600	1300
* 1800	1500
* 2000	1800



ART. 810

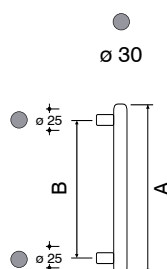

A	B
300	210
350	210
400	300
500	300
600	400
800	600
1000	700
1200	900
1500	1300
* 1600	1300
* 1800	1500
* 2000	1800



* Maniglioni con 3 piedi - * Pull-handles with 3 feet

FISSAGGI - FIXING

FISSAGGIO PER LEGNO

FIXING FOR WOOD DOOR



FISSAGGIO SINGOLO PER VETRO

SINGLE GLASS FIXING



800



810



FINITURE - FINISHING

F60

Inox satinato
Satin steel



800/20

800/25

ART. 800/20

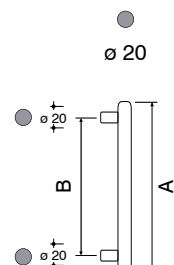

A	B
300	200
500	300
800	500
1200	900
* 1600	* 1300

* Su richiesta

* On request

ART. 800/25

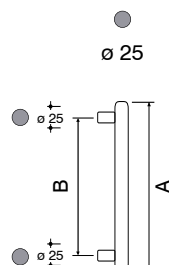

A	B
300	200
400	300
500	300
600	400
800	600
1000	700
1200	900
* 1600	* 1300



ART. 802/20

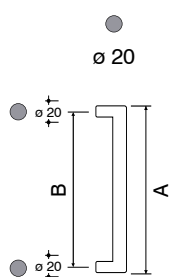

802/20

802/25

A	B
220	200

* Su richiesta

* On request

ART. 802/25

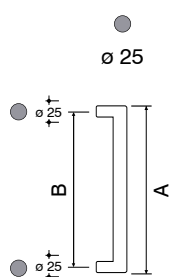

A	B
225	200
325	300
625	600
925	900
* 1225	* 1200



FINITURE - FINISHING

F60

Inox satinato
Satin steel



807

40
20

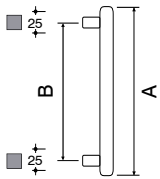

A	B
600	300
1200	900
1600	1300
1800	1500



814

ø 30

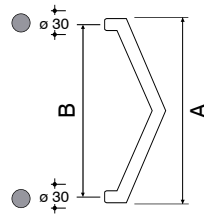

A	B
330	300
380	350



816

ø 30

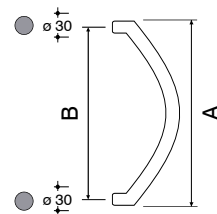

A	B
330	300
380	350



FINITURE - FINISHING

F60

Inox satinato
Satin steel



329K

50 x 50 mm



329KS

50 x 50 mm



327K

50 x 50 mm



327KS

50 x 50 mm



327

ø 52 mm



327GK

ø 52 mm



326

ø 50-60 mm



326GK

ø 50 mm





PLACCHE SICUREZZA

SECURITY PLATE

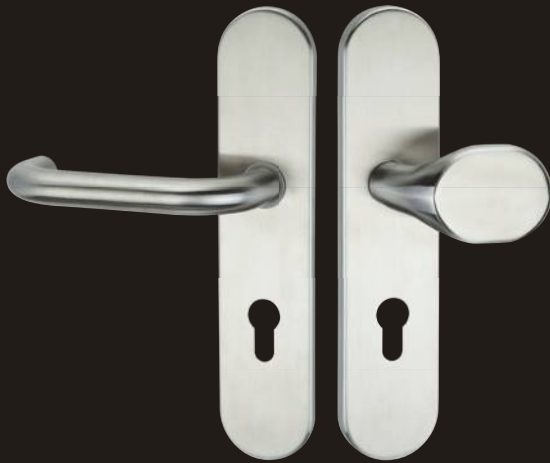

101/200Se/360



101/200Se

Placche utilizzabili con tutti i modelli di maniglie nel programma inox. Disponibile in tutte le distanze e tutti i fori

The plates can be matched with all handles in our inox range. Available with all distance and holes

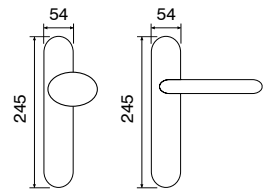

PLACCHE CORTE

SHORT PLATE



101/202S/327



101/202S

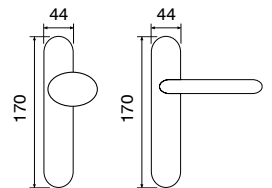

FINITURE - FINISHING

F60

Inox satinato
Satin steel



SET PER PORTA ENTRATA

HANDLE FOR ENTRANCE DOORS



103/284

ART. 103/284

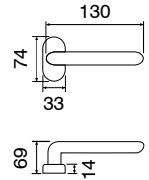

104/284

ART. 104/284

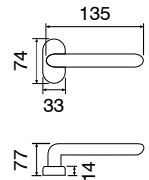

101/284

ART. 101/284

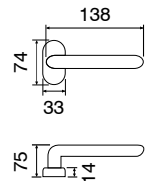

102/284

ART. 102/284

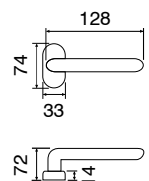

maniglia ø 22 mm con sotto-rosetta in metallo con doppia molla utilizzabile per funzione destra o sinistra.

handles ø 22 mm with under-roses in metal with double function system right or left.

FINITURE - FINISHING

F60

Inox satinato
Satin steel



ROSETTE SICUREZZA

SECURITY ROSES

2078



2079



284



2081E



2080



2035S



2032S



ART. 2078

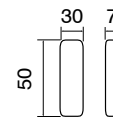

ART. 2079

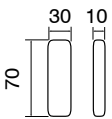

ART. 284

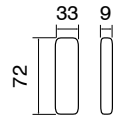

ART. 2081E

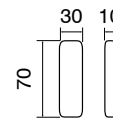

ART. 2080

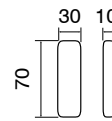

ART. 2035S

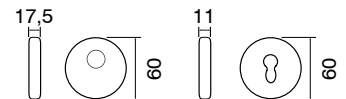

ART. 2032S

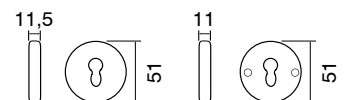

DK SICUREZZA

SECURITY DK



060



050

ART. 050



ART. 060

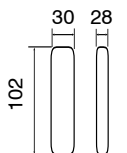

ART. 060

movimento DK
in zama con chiave.

*inner mechanism
for DK with key.*

FINITURE - FINISHING

Disponibile in diverse finiture

Available in different finishing



DOOR STOPPER

3691



3690 I

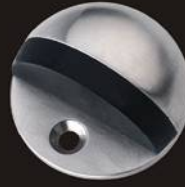

ART. 3691



ART. 3690 I



3665 IC

40x120 mm



3665 IF

40x120 mm



312

ø 52 mm



312 L/O

ø 52 mm



FINITURE - FINISHING

F60

Inox satinato
Satin steel

ART. 070

movimento DK
in metallo

*inner mechanism
for DK in metal*

070



080



ART. 080

movimento DK
in plastica

*inner mechanism
for DK in plastic*

 **FERRI** QUADRI
SQUARE SPINDLES

FERRO DUE FRESATE

∅ 6 - 7 - 8 - 8,5 - 9 - 10 mm



FERRO ESPANSIONE

∅ 8



FERRO CON FORI DECENTRATI

∅ 8 - 8,5 - 9 mm

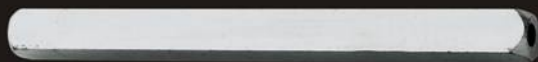

MAGGIORAZIONE PER QUADRO



FERRO NIPLES

∅ 8 - 9 - 10 mm



F60

Inox satinato
Satin steel

FINITURE - FINISHING



1986



FIMET





F01E	Ottone lucido - Ebano	<i>Polish brass - Ebony</i>
F06	Nikel nero	<i>Black nikel</i>
F07	Ottone lucido - Nikel nero	<i>Polish brass - Black nikel</i>
F08	Ottone lucido - Cromo lucido	<i>Polish brass - Chrome</i>
F09	Bianco - Ottone lucido	<i>White - Polish brass</i>
F10	Ottone lucido - Ottone satinato	<i>Polish brass - Satin brass</i>
F11	Cromo lucido - Nikel satinato	<i>Chrome - Satin nikel</i>
F11PVD	Cromo lucido - Nikel satinato PVD	<i>Chrome - Satin nikel PVD</i>
F12	Ottone lucido - Nikel satinato	<i>Polish brass - Satin nikel</i>
F13	Ottone lucido - Pino	<i>Polish brass - Pine</i>
F14	Ottone bronzato - Pino	<i>Bronzed brass - Pine</i>
F15	Ottone lucido - Pino tinto noce	<i>Polish brass - Pine painted walnut</i>
F16	Ottone bronzato - Pino tinto noce	<i>Bronzed brass - Pine painted walnut</i>
F17	Bianco	<i>White</i>
F19	Ottone lucido non verniciato	<i>Unpainted brass</i>
F21E	Nikel lucido - Ebano	<i>Nikel - Ebony</i>
F31	Cromo lucido - PVD	<i>Polish chrome - PVD</i>
F32	Cromo satinato - PVD	<i>Satin chrome - PVD</i>
F33	Cromo lucido - Nero	<i>Polish chrome - Black</i>
F34	Cromo satinato - Bianco	<i>Satin chrome - White</i>
F62	Ottone satinato - Inox satinato	<i>Satin brass - Satin steel</i>
F63	Inox satinato - Inox lucido	<i>Satin steel - Polish steel</i>
F64	Ottone lucido - Inox satinato	<i>Polish brass - Satin steel</i>
F65	Cromo lucido - Inox satinato	<i>Polish chrome - Satin steel</i>
F66	Cromo lucido - Cromo satinato	<i>Polish chrome - Satin chrome</i>
F80	Cromo lucido - Bianco	<i>Polish chrome - White</i>
F81	Cromo lucido - Nikel nero	<i>Polish chrome - Black nikel</i>
F85	Ottone lucido - Faggio	<i>Polish brass - Beechwood</i>
F86	Ottone lucido - Radica	<i>Polish brass - Brierwood</i>
F87	Cromo lucido - Faggio	<i>Polish chrome - Beechwood</i>
F88	Bronzo antico - Faggio	<i>Aged bronzed brass - Beechwood</i>
F90	Cromo satinato - Acero	<i>Satin chrome - Maple</i>
F92	Cromo satinato - Faggio	<i>Satin chrome - Beechwood</i>
F94	Cromo lucido - Cromo opaco	<i>Polish chrome - Opaque chrome</i>
F95	Ottone lucido - Madreperla	<i>Polish brass - Pearl</i>

Colori RAL disponibili - *Available RAL colours*

RAL 7048

RAL 9005

RAL 9010

RAL 8019

RAL 9006

RAL 9016

Tutti gli altri colori RAL sono disponibili su richiesta - *All other RAL colours available on request*



Oro - Pavè

Gold - Pavè

F101



Argento - Pavè

Silver - Pavè

F102



Oro

Gold

F00



Titan PVD

Titan PVD

F18



Ottone lucido

Polish brass

F01



Ottone satinato

Satin brass

F02



Ottone bronzato

Bronzed brass

F03



Cromo lucido

Polish chrome

F04



Cromo satinato

Satin chrome

F05



Nikel satinato

Satin nikel

F20





F21

Nikel lucido
Polish nikel



F22

Peltro
Pewter



F23

Bronzo antico
Aged bronzed brass



F58

Oro francese
Antic french



F43

Bronzo satinato
Satin bronze



F45

Ferro antico
Antic iron



F50

Bronzo scuro
Dark bronze



F55

Bronzo chiaro - Bronzo scuro
Light bronze - Dark bronze



F60

Inox satinato
Satin steel



F99

Argento vecchio
Old silver



La certificazione DIN EN 1906 è una regolamentazione internazionale ed europea per maniglie e pomoli per porte su rosette o placche. La norma DIN EN 1906 stabilisce quattro categorie d'uso in base alla frequenza e alle altre condizioni di utilizzo definite come segue:

CLASSE 1:

Media frequenza di utilizzo, da parte delle persone che esercitano la massima cura, e con basso rischio di abuso.

Per esempio: porte in case private.

CLASSE 2:

Media frequenza di utilizzo, da alcune persone che esercitano la cura, e con qualche rischio di abuso.

Per esempio: porte in uffici e altri spazi di lavoro.

CLASSE 3:

Alta frequenza di utilizzo, da enti pubblici o persone senza alcuna cura, ad alto rischio di abuso.

Per esempio: porte nelle aree pubbliche ed edifici pubblici.

CLASSE 4:

Alta frequenza con la possibilità di danni accidentali o atti di vandalismo, ad alto rischio di non utilizzo appropriato.

Per esempio: porte di Stadi, caserme, o altri molto frequentati gli edifici pubblici.

Per ottenere questa certificazione, le nostre maniglie sono state sottoposte a vari test che simulano le varie sollecitazioni alle quali sono normalmente esposte nella vita di tutti i giorni. Le nostre maniglie sono state certificate dall'istituto Ift di Rosenheim.

The certification DIN EN 1906 is an International and European standard for door handles and knobs for doors on backplates or roses. The DIN EN 1906 states four categories of use according to the frequency and other conditions of use as follows:

CLASS 1:

Medium usage frequency, by persons exercising great care, and with low risk of misuse.

For example: doors in private houses.

CLASS 2:

Medium usage frequency, by persons exercising some care, and with some risk of misuse.

For example: doors in offices and other working spaces.

CLASS 3:

High usage frequency, by public or persons with no care, high risk of misuse.

For example: doors in public areas and public buildings.

CLASS 4:

High frequency with possibility of accidental damage or vandalism, high risk of non appropriate usage.

For example: doors of Stadiums, Barracks, or other highly frequented public buildings.

To obtain this certification, our handles have been submitted to various test simulating the different stresses to which they are normally exposed to in everyday's life. Our handles have been certified by the Ift Rosenheim Institute.

- ALBANIA
- AUSTRIA
- BAHRAIN
- BELGIO
- BOSNIA ERZEGOVINA
- BULGARIA
- CIPRO
- COLOMBIA
- CROAZIA
- DUBAI
- FRANCIA
- GERMANIA
- GRECIA
- ISLANDA
- ITALIA
- KOSOVO
- KUWAIT
- LETTONIA
- LIBANO
- LITUANIA
- MACEDONIA
- MALTA
- MAROCCO
- MONTENEGRO
- NIGERIA
- OMAN
- POLONIA
- QATAR
- ROMANIA
- RUSSIA

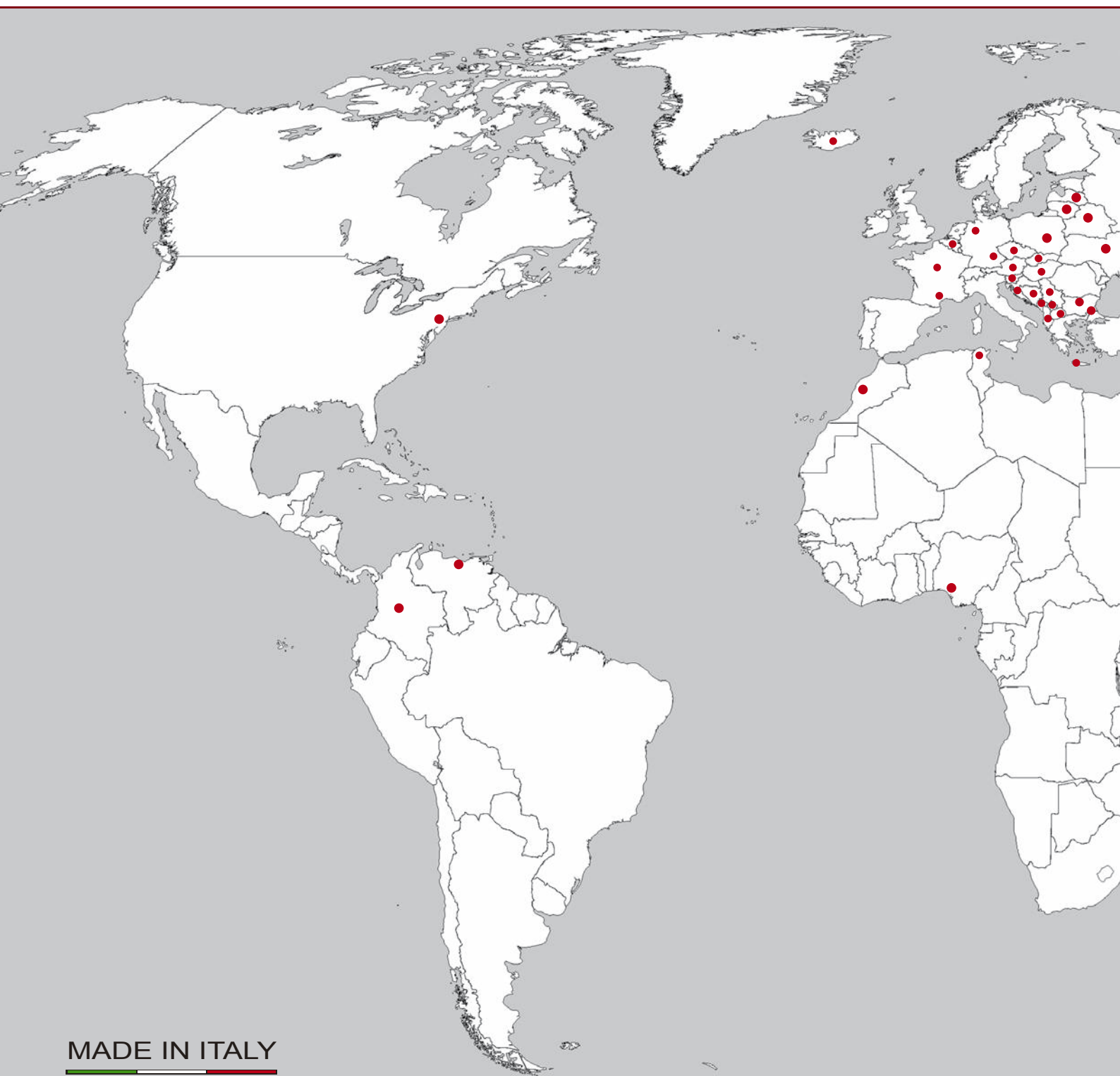

MADE IN ITALY



- SERBIA
- SLOVACCHIA
- SLOVENIA
- SPAGNA
- TUNISIA
- UCRAINA
- UNGHERIA
- USA
- VENEZUELA



FIMET

IN THE WORLD



CONDIZIONI DI VENDITA

- Tutte le vendite vengono effettuate alle condizioni generali della ditta venditrice e potranno essere modificate solo con atto scritto della medesima.
- Tutte le vendite si intendono fatte "salvo approvazione della ditta".
- I prezzi si intendono franco ns. stabilimento. I prezzi sono sempre da intendersi al netto delle vigenti impostazioni fiscali.
- La merce viaggia a rischio e pericolo del committente anche se la spedizione avviene in porto franco
- Non verrà accettata merce in restituzione se non previo benestare della ditta venditrice.
- La ditta garantisce la ottima qualità dei prodotti e si impegna a sostituire solo il materiale che risultasse difettoso per carenza di costruzione.
È però espressamente escluso il risarcimento di ogni eventuale danno.
- È nostra cura effettuare le consegne con la massima velocità consentitaci. Non vengono accettate richieste di risarcimento per ritardi di consegna.
- Qualsiasi reclamo sarà valido solamente se viene fatto per iscritto entro il termine di 8 gg. dal ricevimento della merce.
Il reclamo s'intenderà decaduto qualora il compratore abbia consumato la merce.
In caso di reclamo giustificato forniremo, per la merce resaci allo stato originale, della merce corrispondente all'ordine.
- Le illustrazioni e i dati tecnici riportati sui nostri cataloghi debbono essere considerati approssimativi potendo i modelli subire delle variazioni e modifiche senza obbligo di preavviso da parte della ditta.
- Per ogni controversia che si venisse a creare tra le parti sarà competente l'autorità giudiziaria di brescia.

TERMS OF SALE

- *All sales are made under the Seller's general terms conditions, and modifications may only be made upon written authorisation from the same.*
- *All sales are intended as "subject to the company's approval".*
- *Prices are quoted ex works and after deduction of the relevant taxes.*
- *All goods travel at the Buyer's risk even if despatched carriage free.*
- *Returned goods will only be accepted upon the Seller's approval.*
- *The manufacturer guarantees the quality of the products and undertakes to replace only goods found to have workmanship defects.
Damages will not be refunded.*
- *We will do our utmost to make deliveries as promptly as possible. Claims for delayed deliveries will not be accepted.*
- *Claims will only be valid if made in writing within 8 days of receipt of the goods. Claims will not be valid if the buyer has used the goods.
In the case of justified claims and goods returned in their original state, we will supply goods corresponding to the order.*
- *The drawings and technical data shown in our catalogues are to be considered as approximate since the models are subject to variation or modification at any time without prior notice.*
- *Any disputes between the parties will be put before the Court of Brescia.*